

Installation manual

Washer extractor

W4400H, W4600H, W4850H, W41100H
Clarus Control
Type W4.H.



Electrolux
PROFESSIONAL

CONTACT:

461 Doughty Blvd
Inwood, NY 11096-0338
Tel: 516-371-4400
Fax: 516-371-4204
Email: sales@laundrylux.com

TECH SUPPORT:

Tel: 516-371-0700
Fax: 516-371-4029
Email: techcare@laundrylux.com

PARTS:

Tel: 516-371-2000
Fax: 516-371-4029
Email: parts@laundrylux.com

WARNING: ALL OPERATING AND MAINTENANCE PROCEDURES SHOWN ON THE NEXT PAGE OF THIS MANUAL MUST BE FOLLOWED DAILY FOR PROPER OPERATION OF YOUR MACHINE.

MAKE CERTAIN TO KEEP THIS MANUAL IN A SECURE PLACE FOR FUTURE REFERENCE.

PLEASE ENTER THE FOLLOWING INFORMATION AS IT APPEARS ON THE MACHINE(S) DATA PLATE(S).

MACHINE TYPE OR MODEL	
MACHINE SERIAL NUMBER(S)	
ELECTRICAL CHARACTERISTICS: _____ VOLTS, _____ PHASE, _____ HZ.	

IMPORTANT SAFETY INSTRUCTIONS

WARNING -

To reduce the risk of fire, electric shock, or injury to persons when using your appliance, including the following:

1. Read all instructions before using the appliance.
2. This machine must be securely bolted to an uncovered concrete floor.
3. This machine **MUST** be serviced and operated in compliance with manufacturers instructions.
CHECK DOOR LOCKS EVERY DAY FOR PROPER OPERATION TO PREVENT INJURY OR DAMAGE. IF THE DOOR LOCK FAILS TO OPERATE PROPERLY, PLACE THE MACHINE OUT OF ORDER UNTIL THE PROBLEM IS CORRECTED.
4. Do not wash articles that have been previously cleaned in, washed in, soaked in, or spotted with gasoline, drycleaning solvents, or other flammable or explosive substances, as they give off vapors that could ignite or explode.
5. Do not add gasoline, dry-cleaning solvents, or other flammable or explosive substances to the wash water. These substances give off vapours that could ignite or explode.
6. Under certain conditions, hydrogen gas may be produced in a hot-water system that has not been used for weeks or more. **HYDROGEN GAS IS EXPLOSIVE.** If the hot-water system has not been used for such a period, before using a washing machine, turn on all hot-water faucets and let the water flow from each for several minutes. This will release any accumulated hydrogen gas. As the gas is flammable, do not smoke or use an open flame during this time.
7. Do not allow children to play on or in the appliance. Close supervision of children is necessary when the appliance is used near children.
8. Before the appliance is removed from service or discarded, remove the door.
9. Do not reach into the appliance if the tub is moving.
10. Do not install or store this appliance where it will be exposed to the weather.
11. Do not tamper with controls.
12. Do not repair or replace any part of the appliance or attempt any servicing unless specifically recommended in the user-maintenance instructions or in published user-repair instructions that you understand and have the skills to carry out.
13. Changing of fuses inside the washing machine may only be carried out by authorized personnel.
14. This machine **MUST** be connected to a dedicated electrical circuit to which no other lighting unit or general purpose receptacle is connected. Use copper conductor only.

NOTICE TO: OWNERS, OPERATORS AND DEALERS

IMPROPER INSTALLATION AND INADEQUATE MAINTENANCE, POOR HOUSEKEEPING AND WILLFUL NEGLIGENCE OR BYPASSING OF SAFETY DEVICES MAY RESULT IN SERIOUS ACCIDENTS OR INJURY. TO ASSURE THE SAFETY OF CUSTOMERS AND/OR OPERATORS OF YOUR MACHINE, THE FOLLOWING MAINTENANCE CHECKS MUST BE PERFORMED ON A DAILY BASIS.

1. **Prior to operation of the machine**, check to make certain that all operating instructions and warning signs are affixed to the machine and legible. Missing or illegible ones must be replaced immediately. Be sure you have spare signs and labels available at all times. These can be obtained from your dealer.
2. **Check the door safety interlock, as follows:**
 - a. OPEN THE DOOR of the machine and attempt to start in the normal manner:
For coin-operated models, insert the proper coins to start the machine.
For manually operated models, place the ON-OFF switch in the ON position and press the Start switch.

THE MACHINE(S) MUST NOT START !

- b. CLOSE THE DOOR to start machine operation and, while it is operating, attempt to open the door without exerting extreme force on the door handle. The door should remain locked!
If the machine can start with the door open, or can continue to operate with the door unlocked, the door interlock is no longer operating properly. The machine **must** be placed **out of order** and the interlock immediately replaced.
3. DO NOT UNDER ANY CIRCUMSTANCES ATTEMPT TO BYPASS OR REWIRE ANY OF THE MACHINE SAFETY DEVICES AS THIS CAN RESULT IN SERIOUS ACCIDENTS.
4. **Be sure to keep the machine(s) in proper working order:** Follow **all** maintenance and safety procedures. Further information regarding machine safety, service and parts can be obtained from your dealer.
All requests for assistance must include the model, serial number and electrical characteristics as they appear on the machine identification plate. Insert this information in the space provided on the previous page of this manual.
5. **WARNING:** DO NOT OPERATE MACHINE(S) WITH SAFETY DEVICES BYPASSED, REWIRED OR INOPERATIVE! DO NOT OPEN MACHINE DOOR UNTIL DRUM HAS STOPPED ROTATING!

NOTICE TO INSTALLER

Improper installation of this machine:

- May cause serious damage to the machine.
- May result in other property damage.
- May cause personal injury.
- Will void the manufacturer's warranty.

Improper fastening of this machine to its foundation, inferior foundation materials, an undersized foundation, the use of fabricated steel bases not provided by Electrolux Professional or its approved supplier(s), the use of an improper type, number, or size of mounting bolts, or failure to use proper hardware on mounting bolts may result in damage to the machine that will not be covered by the manufacturer's warranty.

Connection to line Voltage or over-current protection devices other than those specified on the data plate may result in severe damage to machine components, and will void the manufacturer's warranty.

Refer to complete installation instructions provided in manuals accompanying the machine.

Contact Electrolux Professional Technical Support with any questions BEFORE installing this machine. Damage resulting from inadequate installation materials or improper installation techniques will void the manufacturer's warranty.

Contents

Contents

1	Safety Precautions	9
1.1	General safety information.....	9
1.2	Commercial use only.....	9
1.3	Copyright	9
1.4	Symbols.....	10
2	Warranty terms and exclusions.....	11
3	Technical data.....	12
3.1	Drawing	12
3.1.1	W4400H	12
3.1.2	W4600H	13
3.1.3	W4850H	14
3.1.4	W41100H	15
3.2	Technical data	16
3.3	Connections	16
4	Setup	17
4.1	Unpacking.....	17
4.2	Recycling instruction for packaging	20
4.3	Siting	21
4.4	Mechanical installation	21
4.4.1	Drilling points	22
5	Water connection	25
6	Steam connection	27
7	Compressed air connection.....	28
8	Drain connection	29
9	Ventilation.....	30
10	Detergent supply injector	30
11	Connection of external dosing systems	31
11.1	Connection of the hoses.....	31
11.2	Electrical connection of external dosing system.....	32
12	Electrical connection.....	32
12.1	Electrical connections	34
13	Installation of machines with tilt function.....	36
14	Disposal information	43
14.1	Appliance recyclability and disposal	43
14.1.1	Recyclability.....	43
14.1.2	Procedure regarding appliance disposal and component / material recovery.....	43
14.2	Disposal of packing.....	43

The manufacturer reserves the right to make changes to design and component specifications.

1 Safety Precautions

- Servicing shall be carried out only by authorized personnel.
- Only authorized spare parts, accessories and consumables shall be used.
- Only use detergent intended for water-wash of textiles. Never use dry cleaning agents.
- The machine shall be connected with new water hoses. Re-used water hoses must not be used.
- The machine's door lock must under no circumstances be bypassed.
- If the machine develops a fault, this must be reported to the person in charge as soon as possible. This is important both for your safety and that of others.
- DO NOT MODIFY THIS APPLIANCE.
- When performing service or replacing parts, the power must be disconnected.
- When the power is disconnected, the operator must see that the machine is disconnected (that the plug is removed and remains removed) from any point to which he has access. If this is not possible, due to the construction or installation of the machine, a disconnection with a locking system in the isolated position shall be provided.
- In accordance with the wiring rules: mount a multi-pole switch prior to the machine to facilitate installation and service operations.
- If different rated voltages or different rated frequencies (separated by a /) are stated at the machine data plate, instructions for adjusting the appliance for operation at the required rated voltage or rated frequency are stated in the installation manual.
- Stationary appliances not fitted with means for disconnection from the supply mains having a contact separation in all poles that provide full disconnection under overvoltage category III, means for disconnection must be incorporated in the fixed wiring in accordance with the wiring rules.
- The openings in the base, shall not be obstructed by a carpet.
- Maximum mass of dry cloth: W4400H: 45 kg / 99 lbs, W4600H: 65 kg / 143 lbs, W4850H: 90 kg / 198 lbs, W41100H: 120 kg / 265 lbs.
- A-weighted emission sound pressure level at working stations:
 - Wash: W4400H: <70 dB(A), W4600H: <70 dB(A), W4850H: <70 dB(A), W41100H: <70 dB(A).
 - With insulation: W4400H: <70 dB(A), W4600H: <70 dB(A), W4850H: <70 dB(A), W41100H: <70 dB(A).
- Maximum inlet water pressure: 1000 kPa / 145 psi
- Minimum inlet water pressure: 50 kPa / 8 psi

1.1 General safety information

The machine is only intended for water-wash use.

Do not hose down the machine with water.

In order to prevent damage to the electronics (and other parts) that may occur as the result of condensation, the machine should be placed in room temperature for 24 hours before being used for the first time.



1.2 Commercial use only

The machine/machines covered by this manual is/are made for commercial and industrial use only.

1.3 Copyright

This manual is intended solely for consultation by the operator and can only be given to third parties with the permission of Electrolux Professional AB company.

1.4 Symbols

	Caution
	Caution, high voltage
	Read the instructions before using the machine

2 Warranty terms and exclusions

If the purchase of this product includes warranty coverage, warranty is provided in line with local regulations and subject to the product being installed and used for the purposes as designed, and as described within the appropriate equipment documentation.

Warranty will be applicable where the customer has used only genuine spare parts and has performed maintenance in accordance with Electrolux Professional AB user and maintenance documentation made available in paper or electronic format.

Electrolux Professional AB strongly recommends using Electrolux Professional AB approved cleaning, rinse and descaling agents to obtain optimal results and maintain product efficiency over time.

The Electrolux Professional AB warranty does not cover:

- service trips cost to deliver and pick up the product;
- installation;
- training on how to use/operate;
- replacement (and/or supply) of wear and tear parts unless resulting from defects in materials or workmanship reported within one (1) week from the failure;
- correction of external wiring;
- correction of unauthorized repairs as well as any damages, failures and inefficiencies caused by and/or resulting from;
 - insufficient and/or abnormal capacity of the electrical systems (current/voltage/frequency, including spikes and/or outages);
 - inadequate or interrupted water supply, steam, air, gas (including impurities and/or other that does not comply with the technical requirements for each appliance);
 - plumbing parts, components or consumable cleaning products that are not approved by the manufacturer;
 - customer's negligence, misuse, abuse and/or non-compliance with the use and care instructions detailed within the appropriate equipment documentation;
 - improper or poor: installation, repair, maintenance (including tampering, modifications and repairs carried out by third parties not authorized third parties) and modification of safety systems;
 - Use of non-original components (e.g.: consumables, wear and tear, or spare parts);
 - environment conditions provoking thermal (e.g. overheating/freezing) or chemical (e.g. corrosion/oxidation) stress;
 - foreign objects placed in- or connected to- the product;
 - accidents or force majeure;
 - transportation and handling, including scratches, dents, chips, and/or other damage to the finish of the product, unless such damage results from defects in materials or workmanship and is reported within one (1) week of delivery unless otherwise agreed;
- product with original serial numbers that have been removed, altered or cannot be readily determined;
- replacement of light bulbs, filters or any consumable parts;
- any accessories and software not approved or specified by Electrolux Professional AB.

Warranty does not include scheduled maintenance activities (including the parts required for it) or the supply of cleaning agents unless specifically covered within any local agreement, subject to local terms and conditions.

Check on Electrolux Professional AB website the list of authorized customer care.

3 Technical data

3.1 Drawing

3.1.1 W4400H

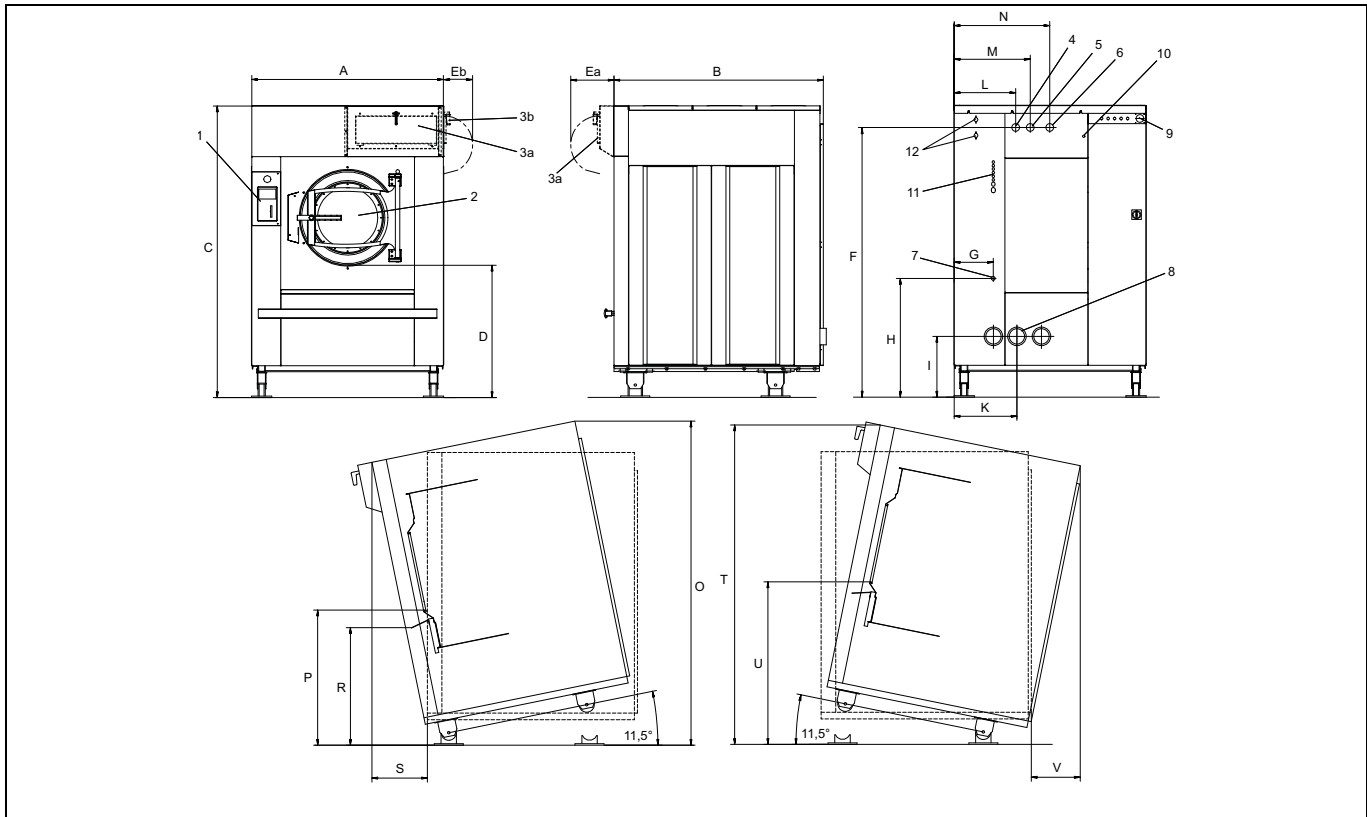

1	Operating panel
2	Door opening, \varnothing 535 mm / 21 1/16 inch
3a	Five-compartment detergent box, front (optional)
3b	Five-compartment detergent box, right hand side (optional)
4	Cold water
5	Hot water
6	Third water (optional)
7	Steam connection
8	Drain
9	Electrical connection
10	Compressed air connection
11	External liquid detergent connections, 6 pcs \varnothing 10 mm / 3/8 inch, 1 pc \varnothing 16 mm / 5/8 inch and 1 pc \varnothing 20 mm / 13/16 inch
12	Water connection, detergent injector, 3/4" (optional)

	A	B	C	D	Ea	Eb	F	G
mm	1325	1450	1975	870	300	210	1825	270
inch	52 3/16	57 1/16	77 3/4	34 1/4	11 13/16	8 1/4	71 7/8	10 5/8

	H	I	K	L	M	N	O	P
mm	780	380	435	425	525	660	2235	950
inch	30 11/16	14 15/16	17 1/8	16 3/4	20 11/16	26	88	37 3/8

	R	S	T	U	V
mm	830	370	2205	1140	345
inch	32 11/16	14 9/16	86 13/16	44 7/8	13 9/16

3.1.2 W4600H

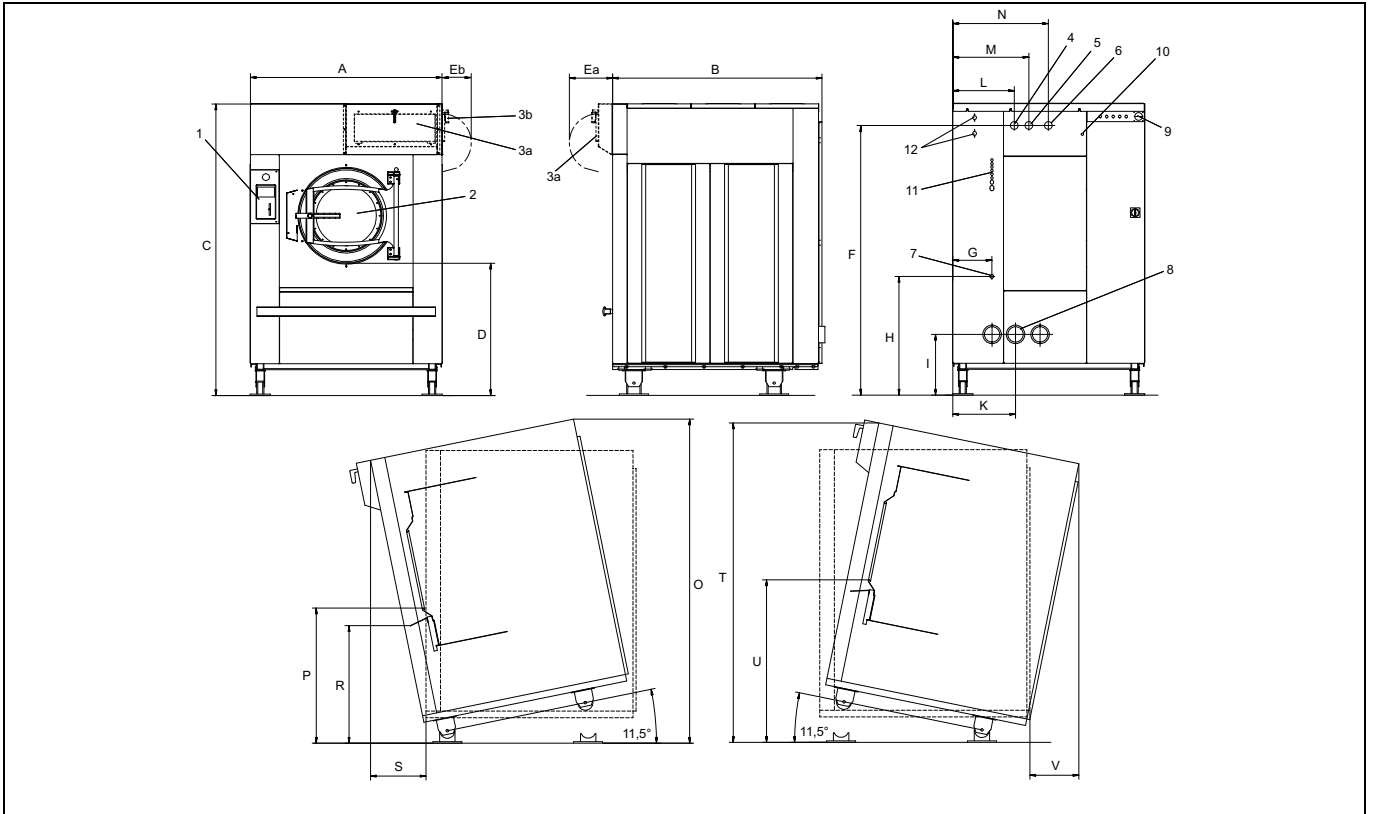

1	Operating panel
2	Door opening, \varnothing 535 mm / 21 1/16 inch
3a	Five-compartment detergent box, front (optional)
3b	Five-compartment detergent box, right hand side (optional)
4	Cold water
5	Hot water
6	Third water (optional)
7	Steam connection
8	Drain
9	Electrical connection
10	Compressed air connection
11	External liquid detergent connections, 6 pcs \varnothing 10 mm / 3/8 inch, 1 pc \varnothing 16 mm / 5/8 inch and 1 pc \varnothing 20 mm / 13/16 inch
12	Water connection, detergent injector, 3/4" (optional)

	A	B	C	D	Ea	Eb	F	G
mm	1390	1585	1975	870	300	210	1825	270
inch	54 3/4	62 3/8	77 3/4	34 1/4	11 13/16	8 1/4	71 7/8	10 5/8

	H	I	K	L	M	N	O	P
mm	780	380	435	425	525	660	2225	935
inch	30 11/16	14 15/16	17 1/8	16 3/4	20 11/16	26	87 5/8	36 13/16

	R	S	T	U	V
mm	815	325	2200	1120	300
inch	32 1/16	12 13/16	86 5/8	44 1/8	11 13/16

3.1.3 W4850H

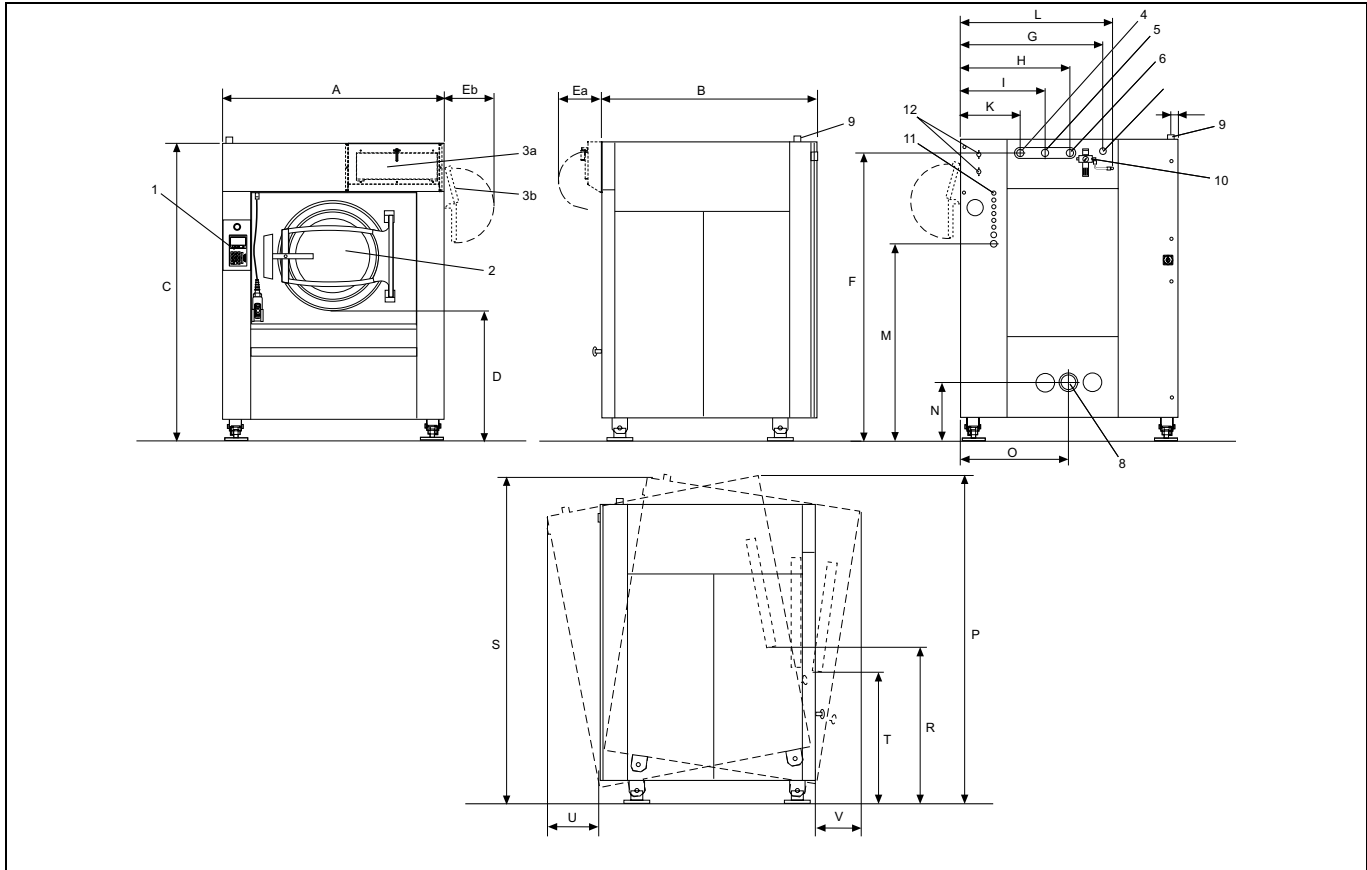

1	Operating panel
2	Door opening, \varnothing 700 mm / 27 9/16 inch
3a	Five-compartment detergent box, front (optional)
3b	Five-compartment detergent box, right hand side (optional)
4	Cold water
5	Hot water
6	Third water (optional)
7	Steam connection
8	Drain
9	Electrical connection
10	Compressed air connection
11	External liquid detergent connections, 6 pcs \varnothing 10 mm / 3/8 inch, 1 pc \varnothing 16 mm / 5/8 inch and 1 pc \varnothing 20 mm / 13/16 inch
12	Water connection, detergent injector, 3/4" (optional)

	A	B	C	D	Ea	Eb	F	G
mm	1640	1635	2230	995	300	380	2135	1070
inch	64 9/16	64 3/8	87 13/16	39 3/16	11 13/16	14 15/16	84 1/16	42 1/8

	H	I	K	L	M	N	O	P
mm	830	635	445	1140	1660	435	820	2410
inch	32 11/16	25	17 1/2	44 7/8	65 3/8	17 1/8	32 5/16	94 7/8

	R	S	T	U	V
mm	1175	2480	960	285	400
inch	46 1/4	97 5/8	37 13/16	11 1/4	15 3/4

3.1.4 W41100H

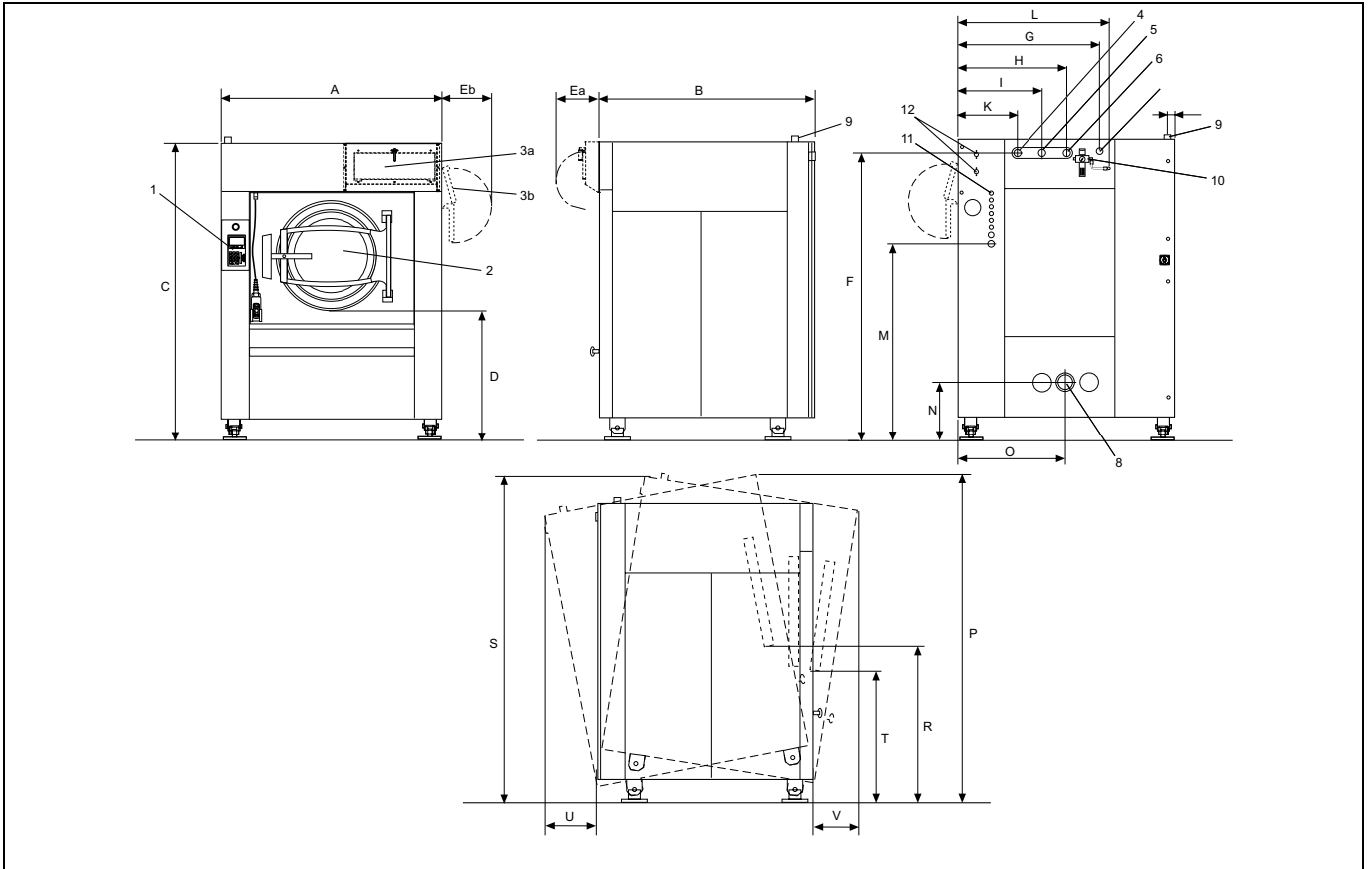

1	Operating panel
2	Door opening, \varnothing 700 mm / 27 9/16 inch
3a	Five-compartment detergent box, front (optional)
3b	Five-compartment detergent box, right hand side (optional)
4	Cold water
5	Hot water
6	Third water (optional)
7	Steam connection
8	Drain
9	Electrical connection
10	Compressed air connection
11	External liquid detergent connections, 6 pcs \varnothing 10 mm / 3/8 inch, 1 pc \varnothing 16 mm / 5/8 inch and 1 pc \varnothing 20 mm / 13/16 inch
12	Water connection, detergent injector, 3/4" (optional)

	A	B	C	D	Ea	Eb	F	G
mm	1640	1850	2230	995	300	380	2135	1070
inch	64 9/16	72 13/16	87 13/16	39 3/16	11 13/16	14 15/16	84 1/16	42 1/8

	H	I	K	L	M	N	O	P
mm	830	635	445	1140	1660	435	820	2400
inch	32 11/16	25	17 1/2	44 7/8	65 3/8	17 1/8	32 5/16	94 1/2

	R	S	T	U	V
mm	1160	2480	955	240	335
inch	45 11/16	97 5/8	37 5/8	9 7/16	13 3/16

3.2 Technical data

		W4400H	W4600H	W4850H	W41100H
Weight, net	kg lbs	1095–1450* 2414–3197	1380–1480* 3042–3263	2200–2300* 4850–5071	2300–2400* 5071–5291
Drum volume	litres ft ³	400 14.1	600 21.2	850 30	1100 38.8
Drum diameter	mm inch	920 36 1/4	980 38 9/16	1220 48 1/16	1220 48 1/16
Drum speed during wash	rpm	37	36	42	42
Drum speed during extraction	rpm	825	800	720	663
G-factor, max.		350	350	350	300
Heating: Electricity	kW	36.0	38.4		
	kW		54.0		
Heating: Steam		x	x	x	x
Heating: Hot water		x	x	x	x
Frequency of the dynamic force	Hz	13.8	13.3	12.0	11.1
Floor load at max extraction	kN lbs force	15.8 ± 1.2 3551 ± 270	16.9 ± 1.4 3800 ± 310	25.9 ± 1.5 5830 ± 340	27.9 ± 2.0 6270 ± 440
A-weighted emission sound pressure level at working stations	dB(A)	75	76	73	73
Sound pressure level at working stations (With insulation)	dB(A)	<70	<70	<70	<70
Power consumption — motor	kW	4.5	4.8	6.3	6.3
Heat emission of installed power, max	%	5	6	6.7	6.8

* Precise weight depends on accessories fitted on the machine.

3.3 Connections

		W4400H	W4600H	W4850H	W41100H
Water valves	DN BSP	25 1"	25 1"	32 1 1/4"	32 1 1/4"
Recommended water pressure	kPa psi	200–600 30–90	200–600 30–90	200–600 30–90	200–600 30–90
Continuous operating pressure	kPa psi	50–1000 8–145	50–1000 8–145	50–1000 8–145	50–1000 8–145
Capacity at 300 kPa	l/min gallon/min	110 30	110 30	150 40	150 40
Drain valve ø outer	mm inch	110 4 5/16	110 4 5/16	110 4 5/16	110 4 5/16
Draining capacity	l/min gallon/min	400 105	400 105	400 105	400 105
Steam valve connection	DN BSP	20 3/4"	20 3/4"	32 1 1/4"	32 1 1/4"
Recommended steam pressure	kPa psi	300–600 44–87	300–600 44–87	300–600 44–87	300–600 44–87
Functioning limits for steam valve	kPa psi	50–800 8–115	50–800 8–115	50–800 8–115	50–800 8–115
Compressed air connection	DN BSP	6 1/8"	6 1/8"	6 1/8"	6 1/8"
Recommended air pressure	kPa psi	500–700 73–102	500–700 73–102	500–700 73–102	500–700 73–102
Air consumption	l/h gallon/h	20 5	20 5	20 5	20 5

4 Setup

4.1 Unpacking

The direction from which the machine must be lifted and the machine centre of gravity are shown on the packaging. Remove the side panels, the rear panel and the lower front panel.

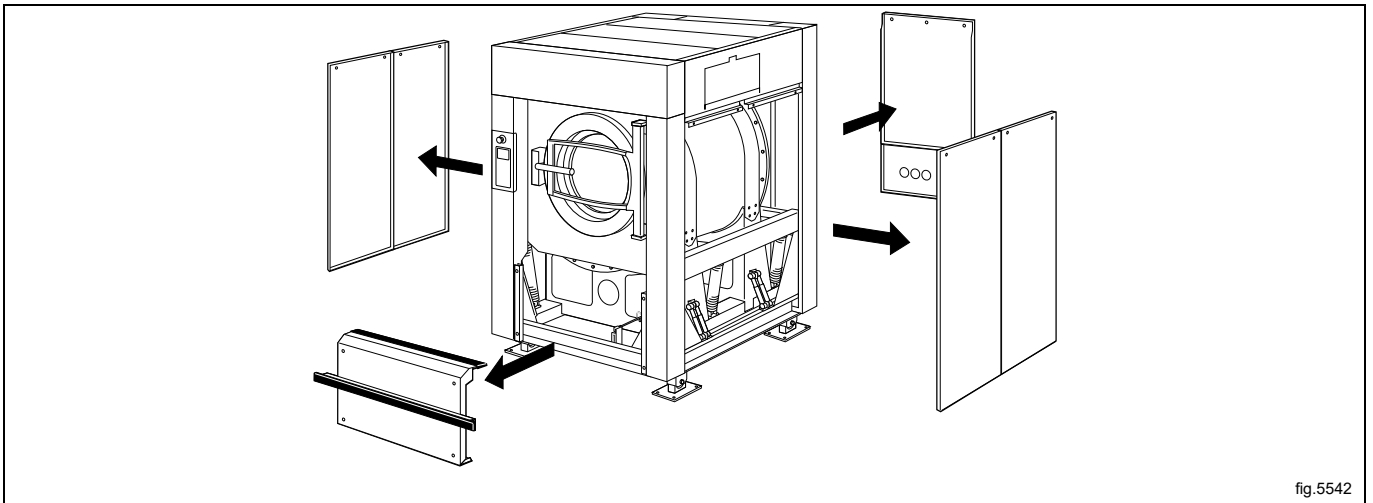

Remove the eight bolts securing the machine's outer- and inner frame onto the pallet.

Note!

If the machine is equipped with weighing equipment, take extra care when removing the bolts, since the load cells fitted by the machine's feet are sensitive to knocks and impacts.

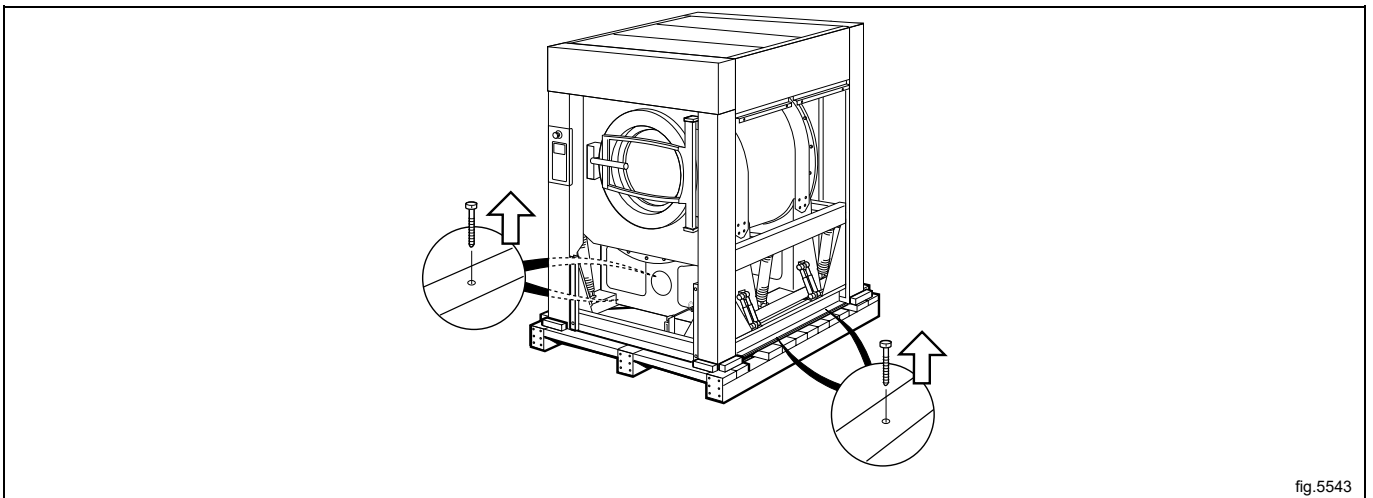

Use a fork-lift truck to lift the machine.

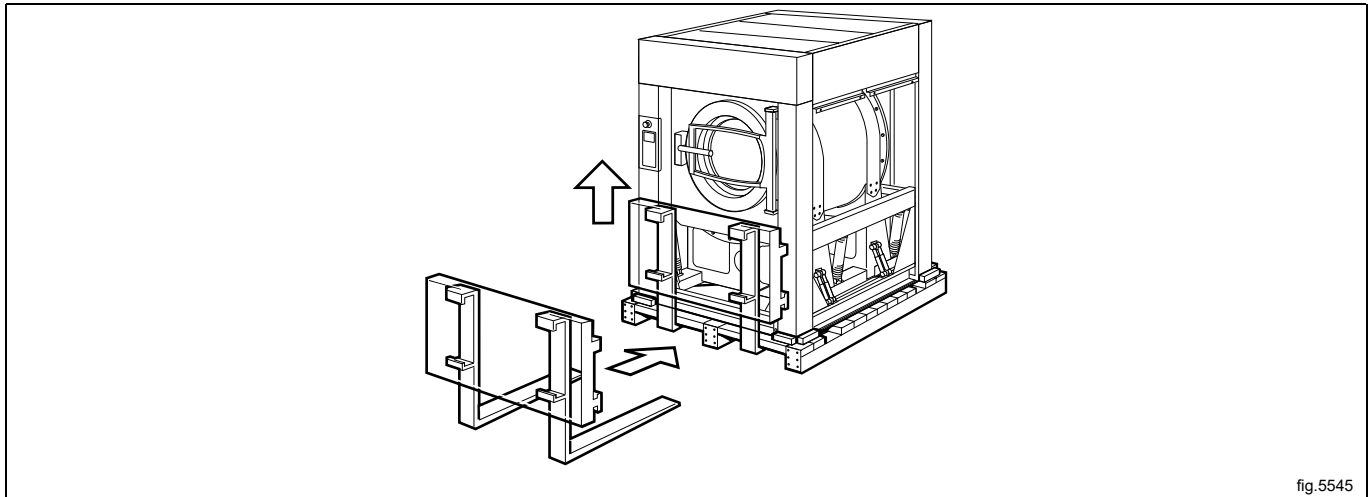

fig.5545

Position the four blocks of wood supplied, one beneath each machine foot (on the outer frame), within the recesses in the pallet.

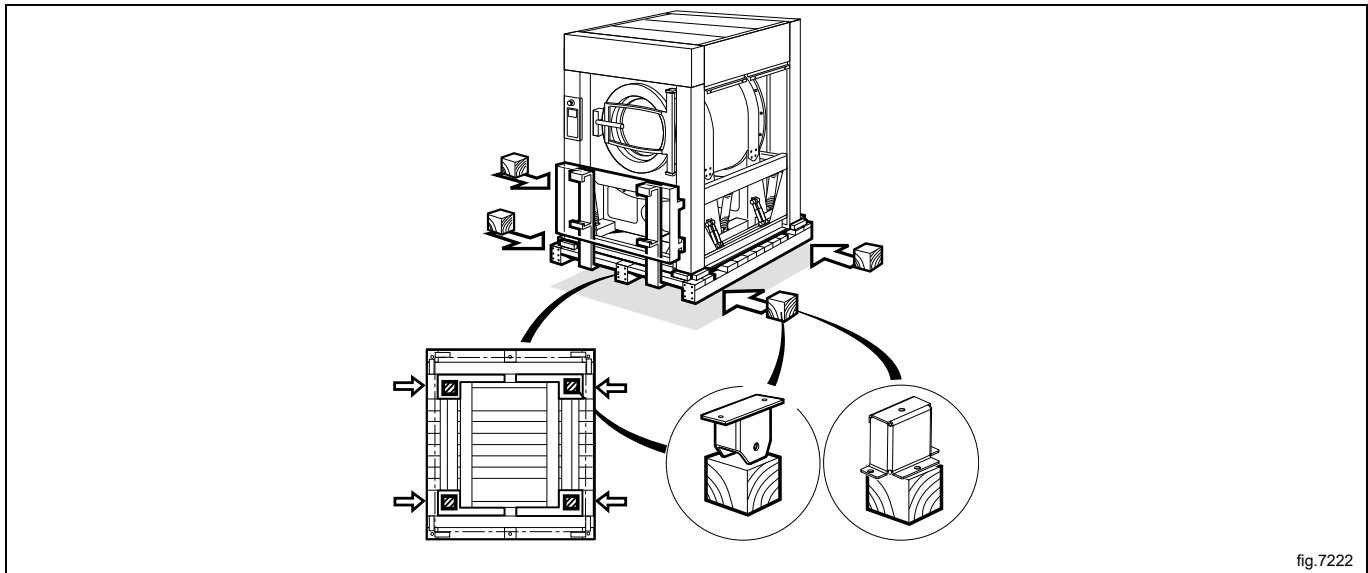

fig.7222

Lower the machine (A) and withdraw the truck forks (B). The machine should now be standing on the four blocks, and the pallet will be on the floor, clear of the machine. The next step is to insert the truck forks very carefully between machine and pallet (C).

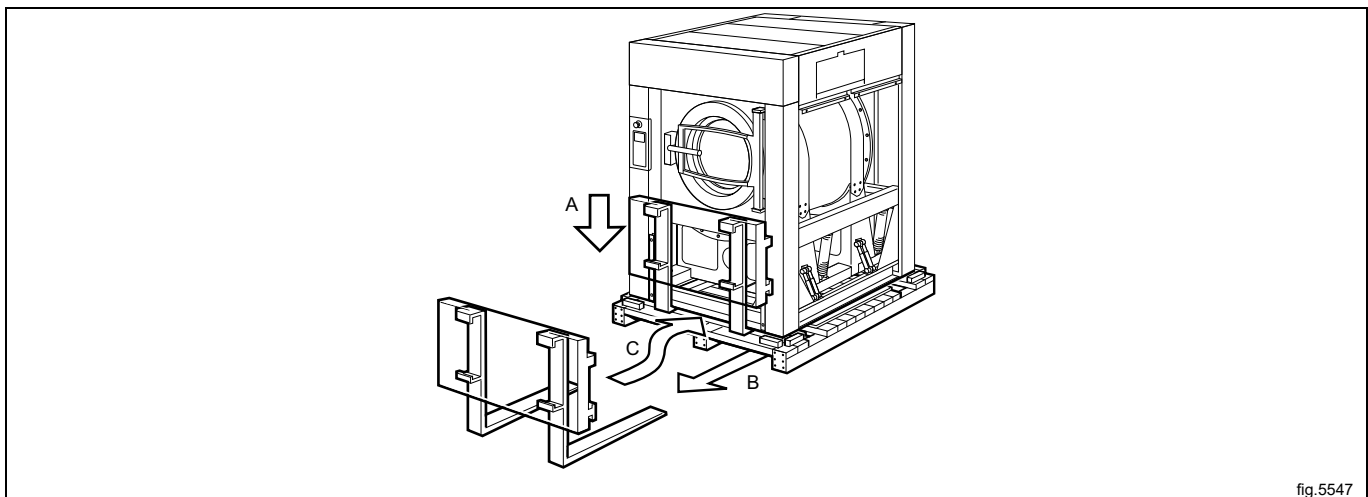

fig.5547

Lift the machine and remove pallet and blocks.

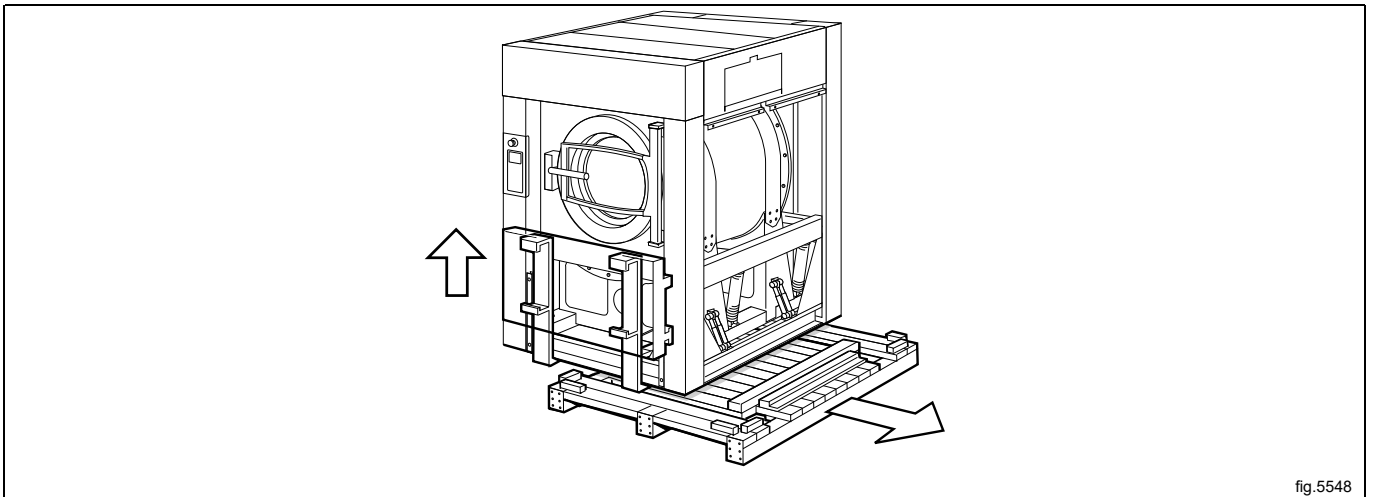

fig.5548

The feet can be of two types: fixed feet or rotating feet if the machine is to be fitted with tilt or weighing equipment. For machines with tilt or weighing equipment: screw on the machine's feet.

Note!

If the machine is to have the tilt function, this is a suitable time to install the corner posts which hold the protective plates, and also, where applicable, the position sensors. (For more information please refer to section "Installation of machines with tilt function").

It is important that the wheels are installed with the wider side facing in towards the machine (D) in order for the tilt protection to fit.

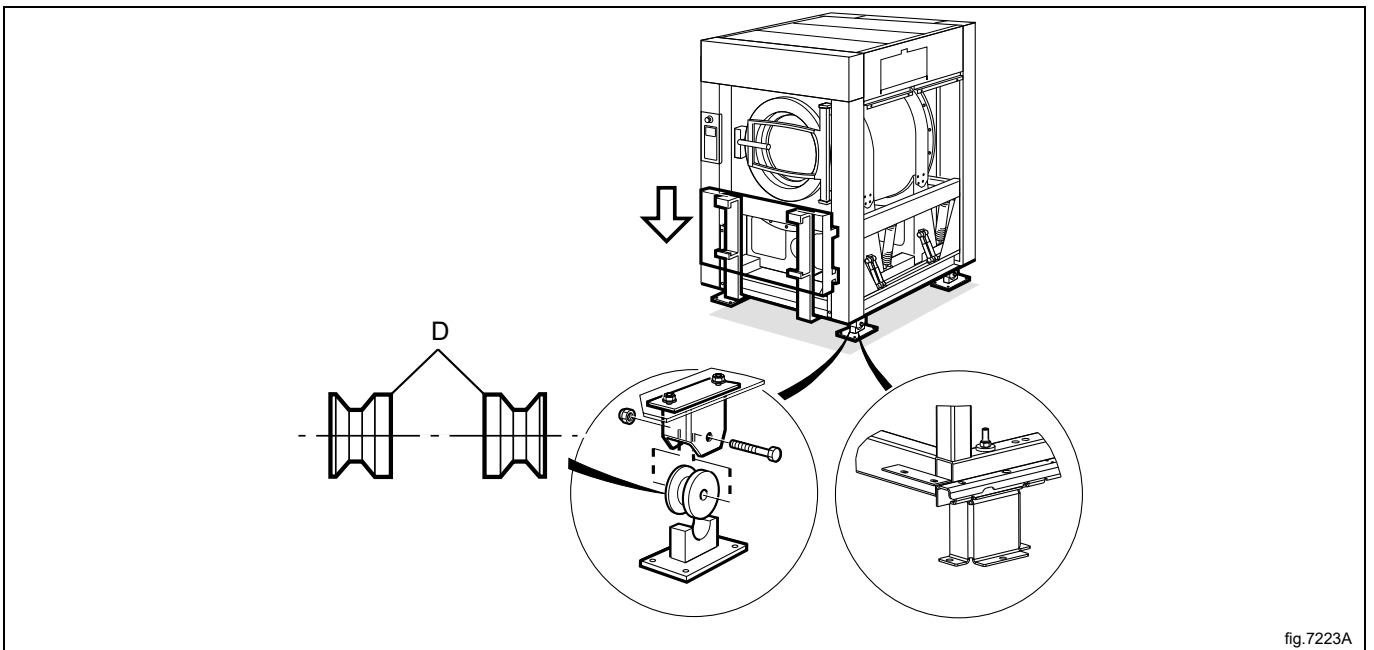

fig.7223A

Note!

When moving the machine, handle it with care.

Place the machine on its final position.

4.2 Recycling instruction for packaging

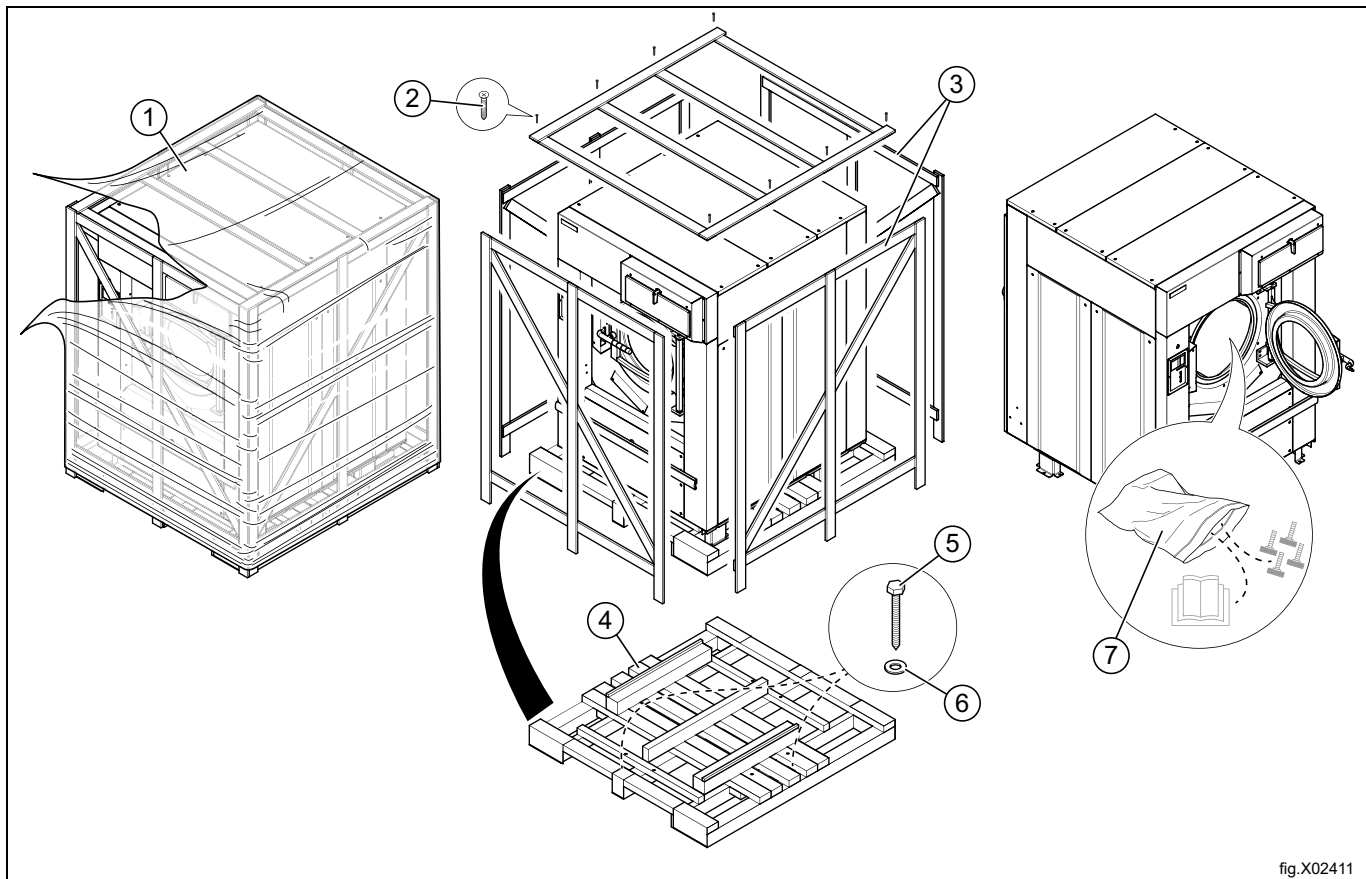

Fig.	Description	Code	Type
1	Wrapping film	LDPE 4	Plastics
2	Screw	FE 40	Steel
3	Packaging	FOR 50	Wood
4	Pallet	FOR 50	Wood
5	Screw	FE 40	Steel
6	Washer	FE 40	Steel
7	Plastic bag	PET 1	Plastics

4.3 Siting

The machine must not be sited over an open floor drain. Check that the floor has an even surface and is in level. The machine should be positioned so that there is plenty of room for working, both for the user and service personnel. The figure shows minimum distance to a wall and/or other machines.

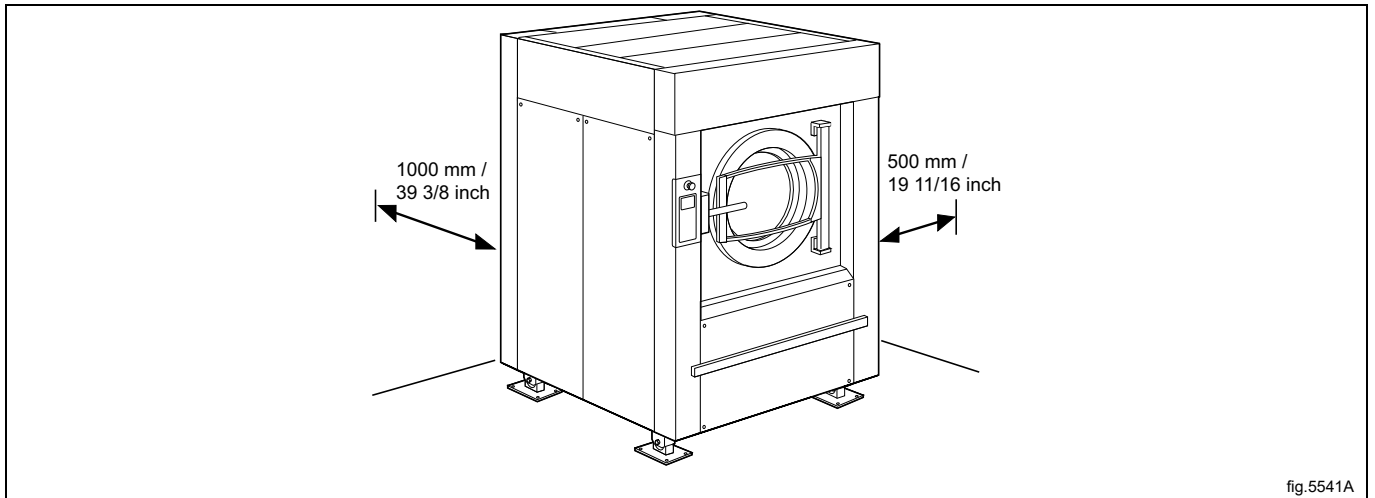

fig.5541A

4.4 Mechanical installation

Put the machine in place. Mark out and drill the holes for fixing the feet. Hole diameter: 15 mm / 9/16 inch.

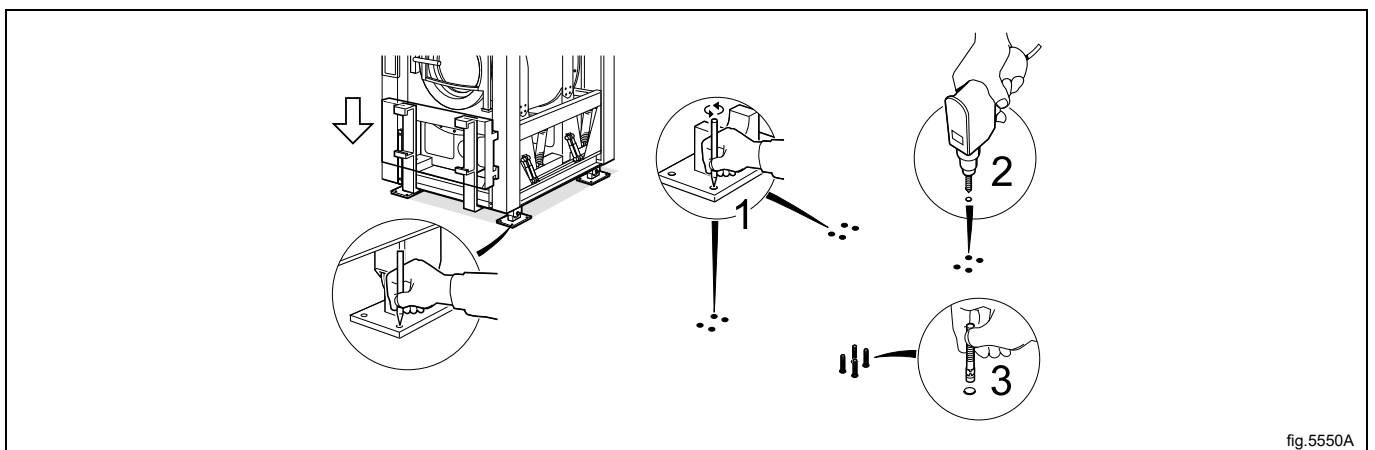

fig.5550A

4.4.1 Drilling points

The following tables shows the correct drilling points.

4.4.1.1 Standard machines

mm inch	W4400H	W4600H	W4850H	W41100H
A	1325 52 3/16	1390 54 3/4	1640 64 9/16	1640 64 9/16
B	1445 56 7/8	1605 63 3/16	1635 64 3/8	1850 72 13/16
C	1160 45 11/16	1315 51 3/4	1370 53 15/16	1585 62 3/8
D	190 7 1/2	190 7 1/2	190 7 1/2	190 7 1/2
E	50 1 15/16	50 1 15/16	50 1 15/16	50 1 15/16
F	1310 51 9/16	1370 53 15/16	1610 63 3/8	1610 63 3/8
G	90 3 9/16	90 3 9/16	90 3 9/16	90 3 9/16
H	10 3/8	10 3/8	15 H 3/8 3/8 9/16	15 H 3/8 3/8 9/16

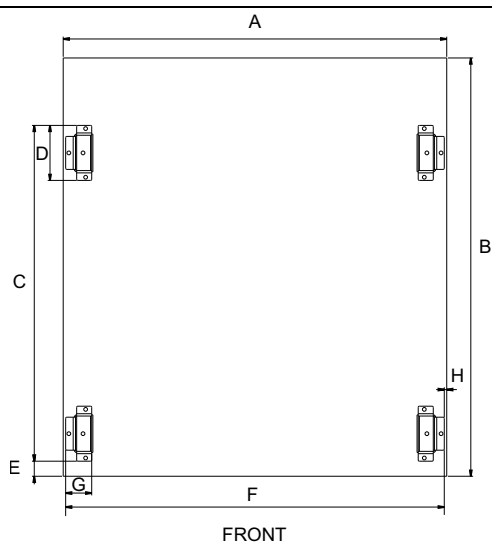

fig.W00141

4.4.1.2 Machines with tilt or weighing equipment

mm inch	W4400H	W4600H	W4850H	W41100H
A	1325 52 3/16	1390 54 3/4	1640 64 9/16	1640 64 9/16
B	1445 56 7/8	1605 63 3/16	1635 64 3/8	1850 72 13/16
C	1170 46 1/16	1325 52 3/16	1380 54 5/16	1600 63
D	200 7 7/8	200 7 7/8	200 7 7/8	200 7 7/8
E	50 1 15/16	45 1 3/4	45 1 3/4	45 1 3/4
F	1340 52 3/4	1400 55 1/8	1640 64 9/16	1640 64 9/16
G	140 5 1/2	140 5 1/2	140 5 1/2	140 5 1/2
H	-10 -3/8	-10 -3/8	0 0	0 0
K	275 10 13/16	275 10 13/16	270 10 5/8	270 10 5/8
L	715 28 1/8	870 34 1/4	925 36 7/16	1140 44 7/8
M	665 26 3/16	695 27 3/8	820 32 5/16	820 32 5/16
N	335 13 3/16	335 13 3/16	335 13 3/16	335 13 3/16
O	335 13 3/16	335 13 3/16	335 13 3/16	335 13 3/16

P = tilting devices

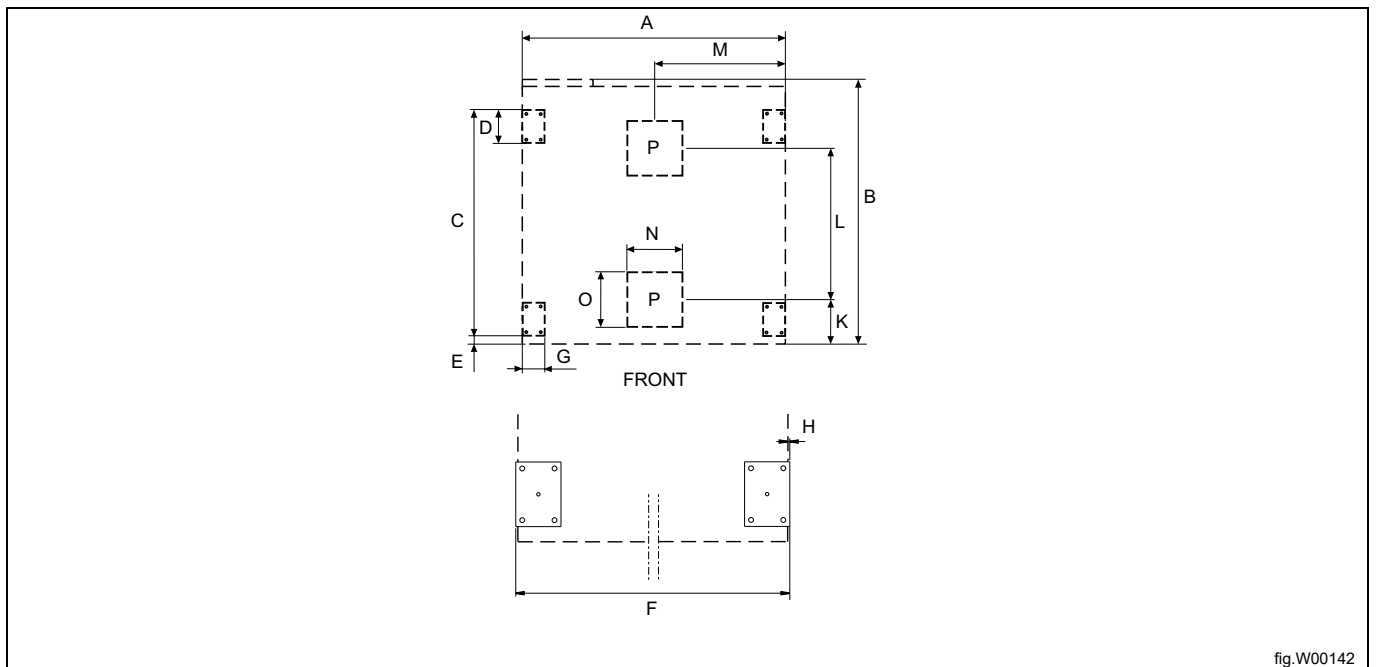

fig.W00142

Use a spirit level and, where necessary, the washers (or rectangular metal plates) supplied, to ensure that the floor mountings are in level.

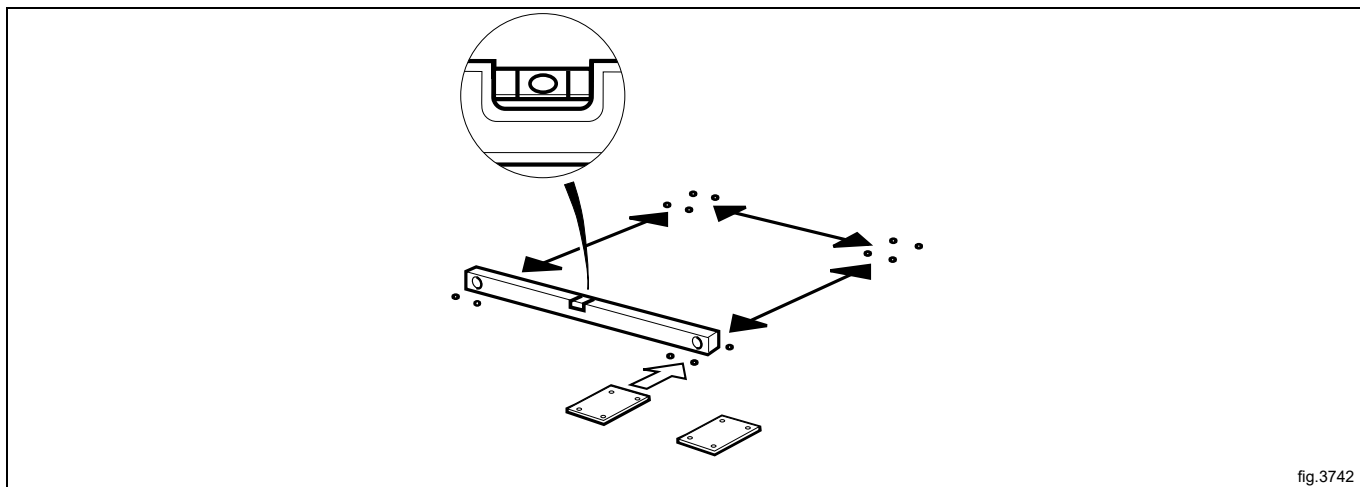

fig.3742

Put the machine in place. Use a spirit level on suitable surfaces of the outer frame to check that the machine is in level. Also check that the machine is resting firmly on all four feet.

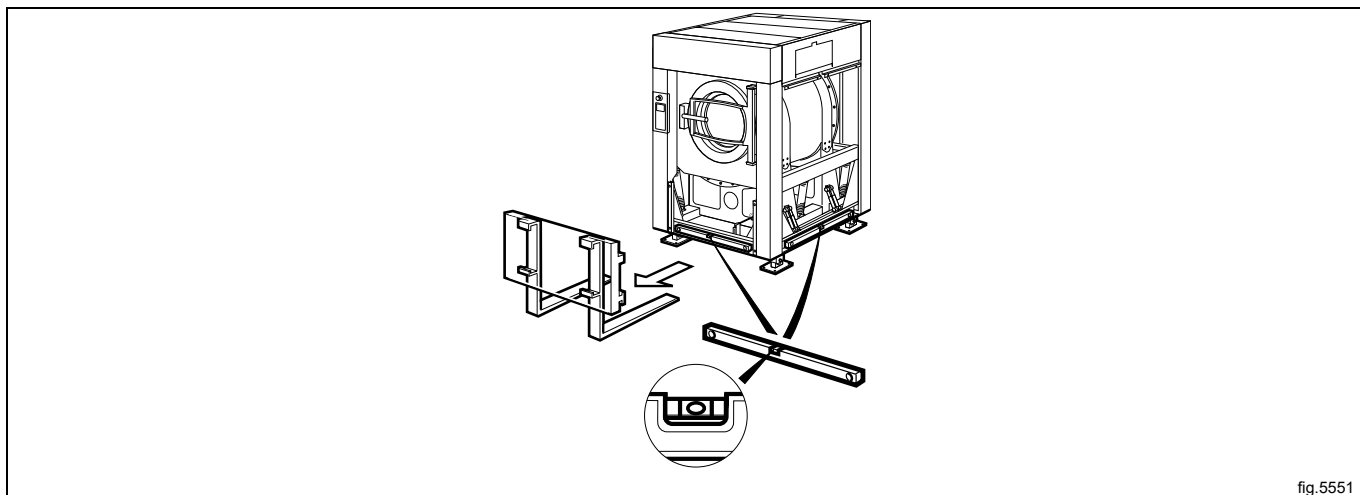

fig.5551

Bolt the machine feet to the floor. Then check again that the machine is resting firmly (without movement) and is in level.

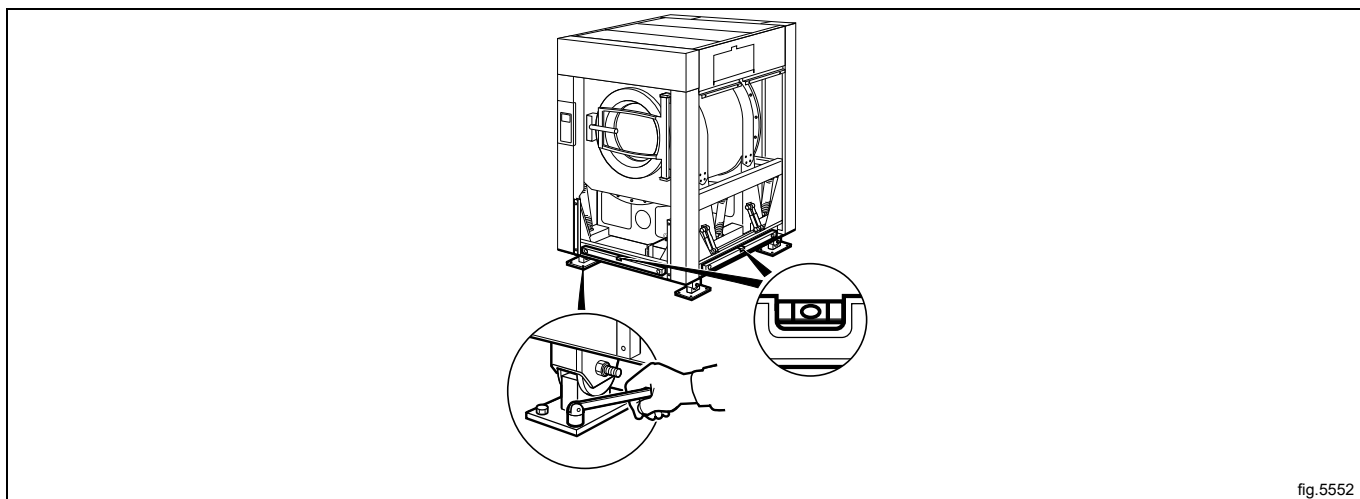

fig.5552

5 Water connection

All water intake connections to the machine should be fitted with manual shut-off valves and filters, to facilitate installation and servicing.

Water pipes and hoses should be flushed clean before installation.

The machine shall be connected with new water hoses. Re-used water hoses must not be used.

Hoses are to be of an approved type and grade and comply with national regulations.

The hoses should be rated for high pressure and for 2.5 MPa

After installation hoses must hang in gentle arcs. (This is particularly important if the machine is fitted with a tilting function). Connections with pipes directly to the machine is not allowed.

All connectors present on the machine must be connected to the water supply or the machine may not function properly. The table shows the possible connection options, which will depend on the water types to be connected to the machine. Information is also available on the panel above the connections.

Note!

The water supply should be within the recommended hardness range of 3 grains or less per gallon. Higher hardness may cause excessive formation of limescale. Chlorides must not exceed 30 ppm. The buildup of limescale will negatively affect operation, performance and warranty approval.

Connect the water:

- Cold water (A)
- Hot water (B)
- Third water (C)

Connection size (W4400H, W4600H): DN 25 (1" BSP).

Connection size (W4850H, W41100H): DN 32 (1 1/4" BSP).

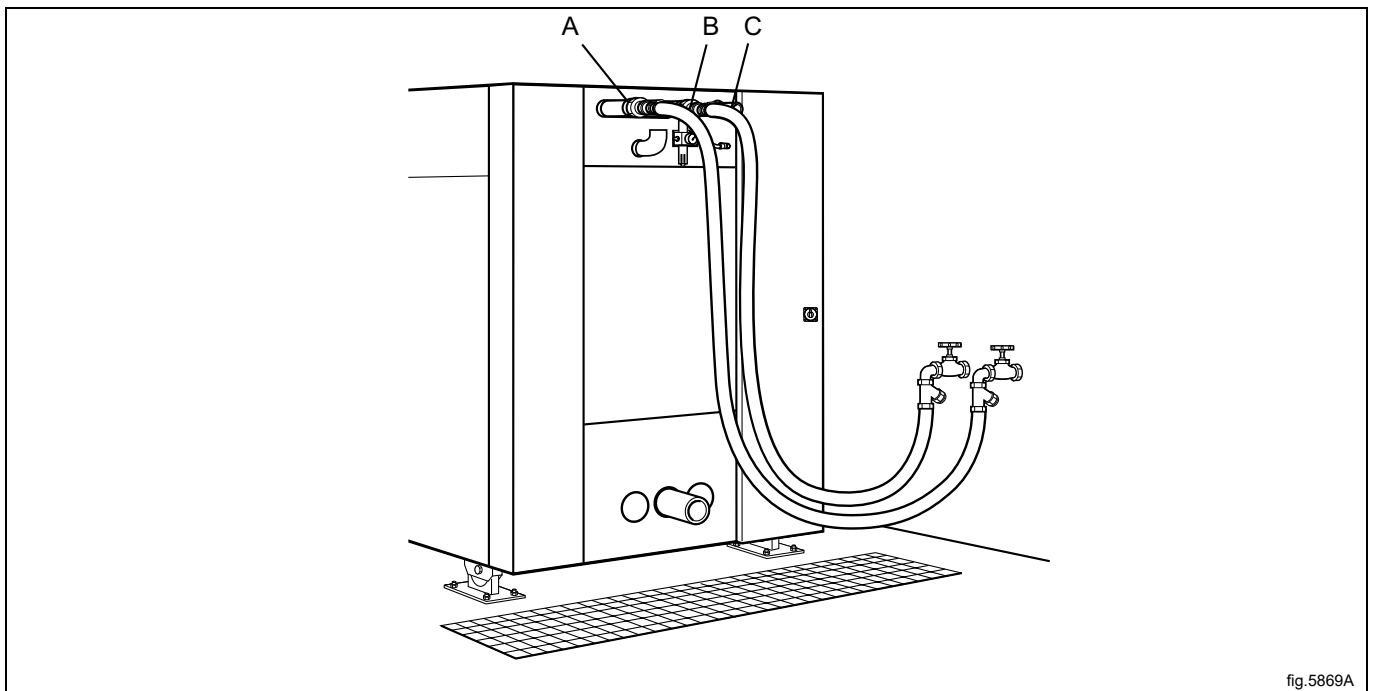

There are DN (BSP) threads at the inlet valves for position (A), (B) and (C).

To connect NH threaded hoses (typical water hoses with garden-hose threads) to DN (BSP) threaded inlet valves (A), (B) and (C), use the adapter fittings provided in the drum package of the machine.

Use the thread seal tape between the inlet valves and the adapter to prevent water leaks.

CAUTION: ATTEMPTING TO ASSEMBLE UNLIKE THREADS WITHOUT USING AN ADAPTER WILL DAMAGE THE VALVE THREADS, RESULTING IN LEAKS.

Water pressure:

Continuous operating pressure: 50–800 kPa / 8–116 psi (0.5-80 kp/cm²)

Maximum: 1000 kPa / 145 psi (10 kp/cm²)

Recommended: 200–600 kPa / 30–90 psi (2–6 kp/cm²)

Recommended water hardness: 3 grains per gallon

Recommended pH-range: 7.0–8.0

Acceptable range for chloride concentration: 0–30 ppm

Note!

If the water pressure is below the minimum value, the wash result can not be guaranteed for certain program.

FOR AUSTRALIA:

The appliance shall be installed in accordance with AS / NZS 3500.1

The appliance need to be installed using dual check valves.

Contact details for after sales service: service.au@electroluxprofessional.com

6 Steam connection

The supply hose must be equipped with a manual shut-off valve to facilitate installation and servicing. Fit filter to the manual shut-off valve.

Connections with pipes directly to the machine are not allowed.

Connect the hose so it hangs in a gentle arc. (This is particularly important if the machine is fitted with a tilting function).

Connect an approved hose between filter and machine.

Connection size at filter (W4400H, W4600H): DN 20 (3/4" BSP).

Connection size at filter (W4850H, W41100H): DN 32 (1 1/4" BSP).

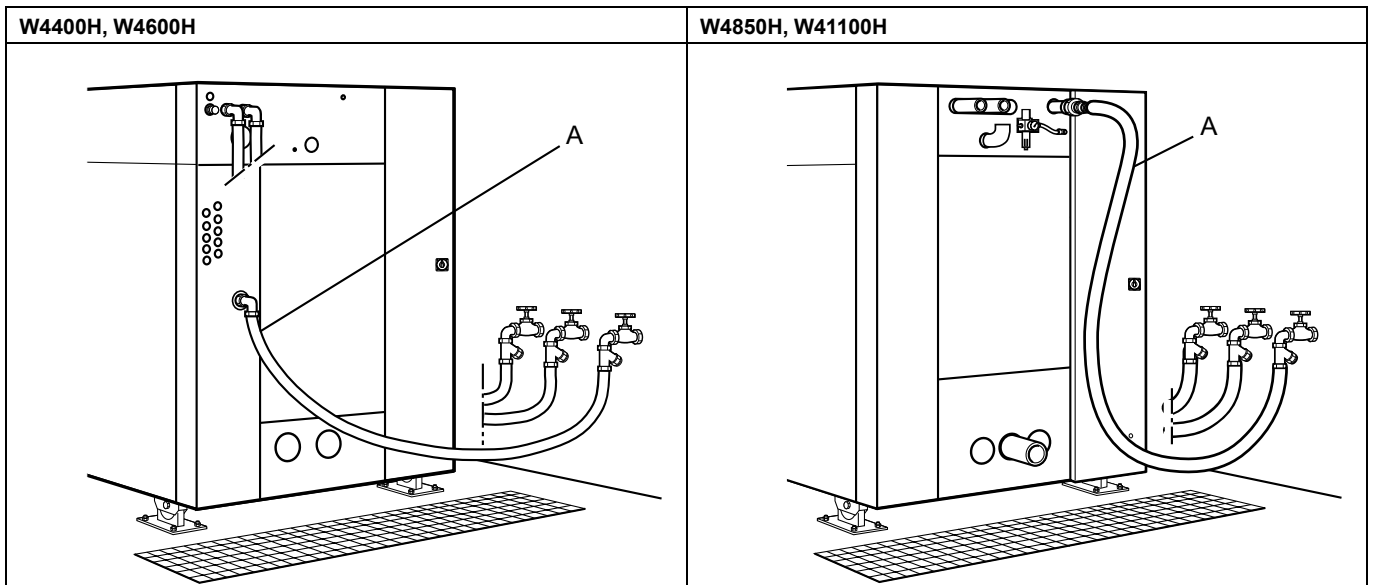

Steam pressure required:

Minimum: 8 psi (50 kPa)

Maximum: 115 psi (800 kPa)

Recommended: 45-90 psi (300-600 kPa)

Note!

A steam heated machine is only intended to use clean steam.

7 Compressed air connection

A pressure regulator complete with water separation device is to be installed on the machine.

When the machine is supplied, the angled coupling (A), hose (B) and bracket (C) for the pressure regulator will already be installed.

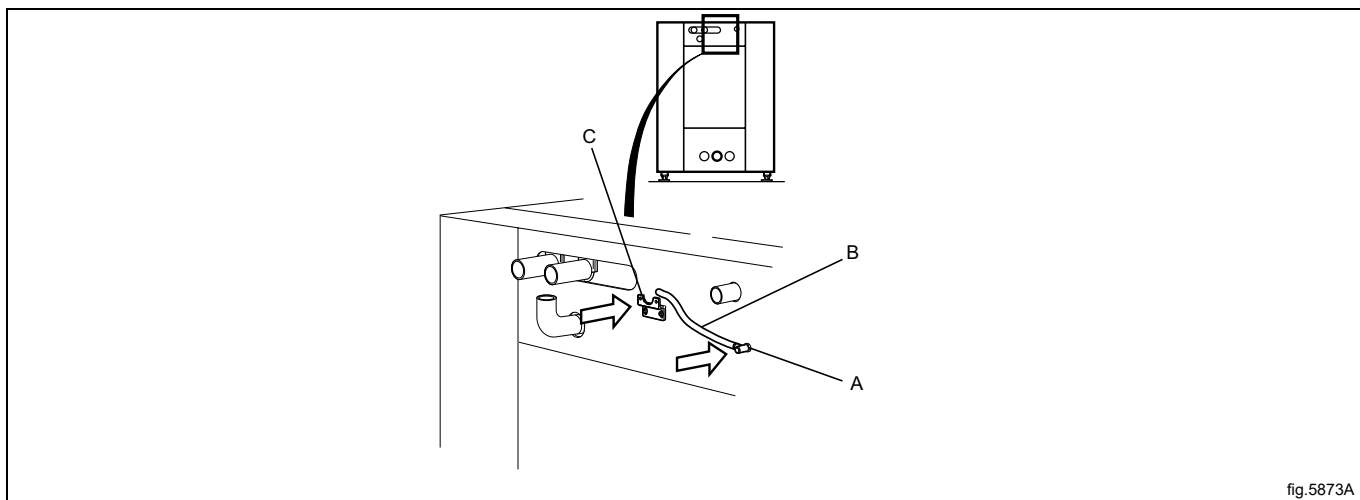

fig.5873A

Install the quick-connector (E) for the hose and a bushing (D) (for the hose from the compressed air supply) on the pressure regulator.

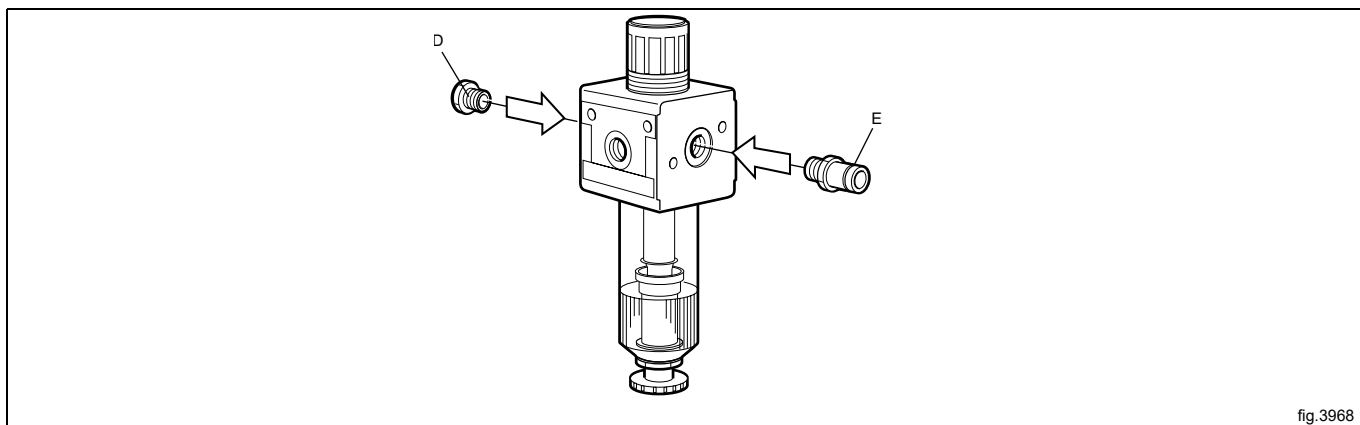

fig.3968

Install the pressure regulator on the bracket using two screws. Connect the compressed air hose using the quick-connector. Screw on the pressure gauge (F).

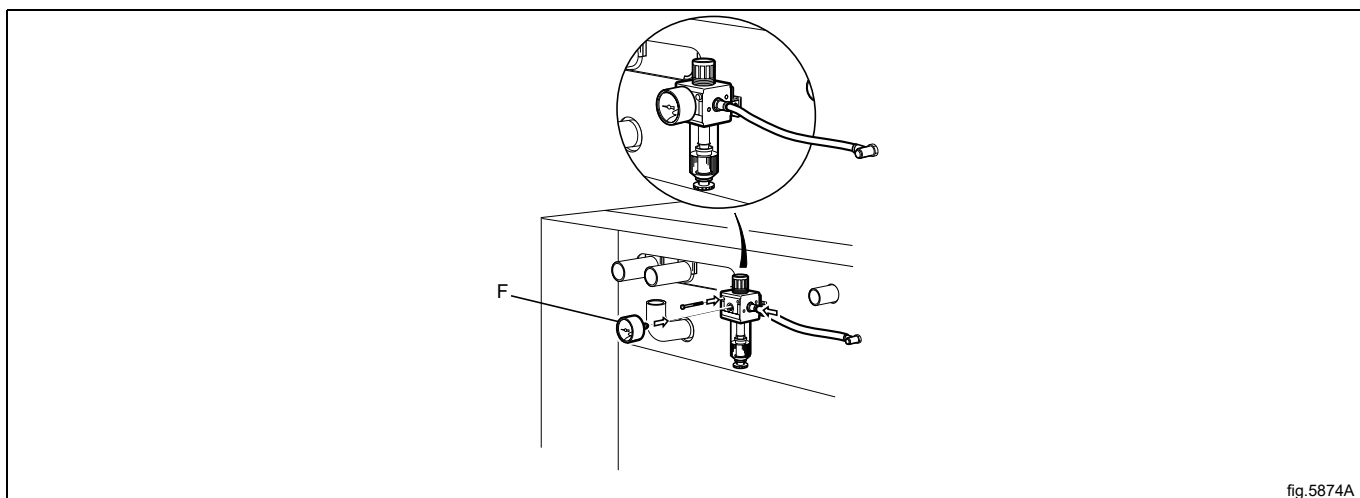
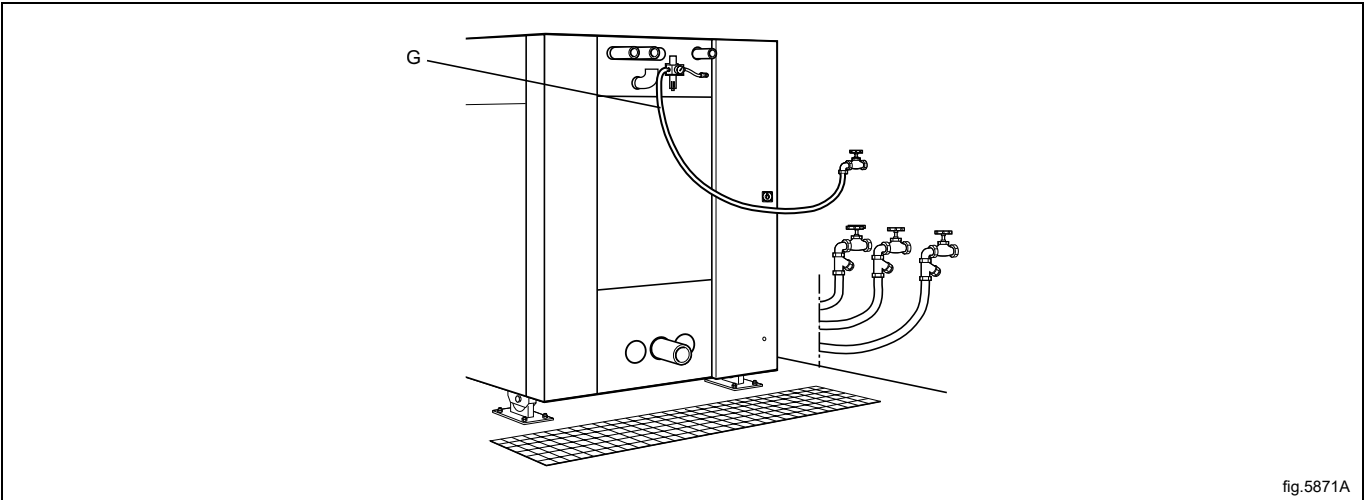

fig.5874A

Connect the hose from the compressed air supply to the bushing on the pressure regulator.

Connect the hose so it hangs in a gentle arc. (This is particularly important if the machine is fitted with a tilting function).

The connecting hose must be rated for a pressure of at least 1 MPa.



8 Drain connection

The connector for the machine discharge (A) has an external diameter of 110 mm. The distance between the machine and the floor gully or drainage channel should be at least 250 mm / 9 13/16 inch.

Connect a hose or a pipe to the drain connection. Avoid sharp bends which may prevent proper draining. The hose or pipe should open into a floor gully, drainage channel or similar waste outlet. Make sure that the hose's function is unaffected if the machine is fitted with a tilting function.

If the machine has a second discharge, B and C must also be connected to the floor drain.

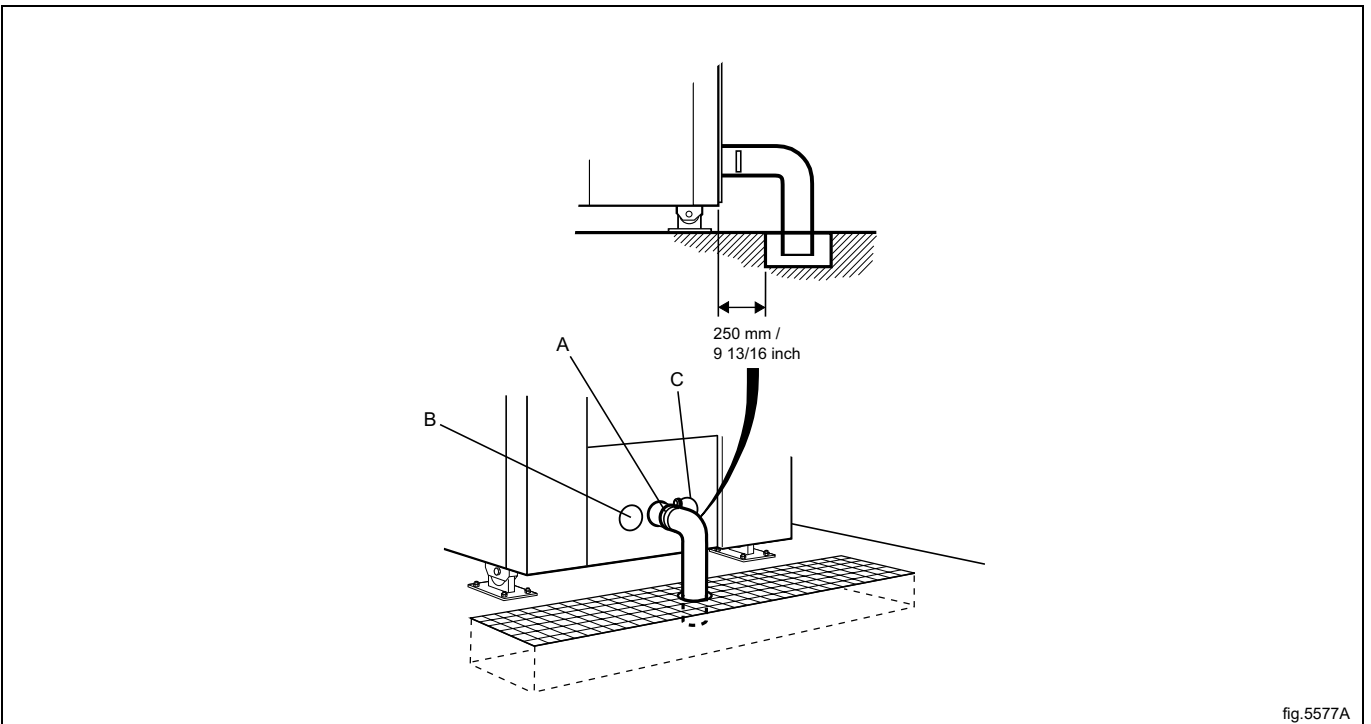

9 Ventilation

The vent (A) from the machine drum is at the back of the machine. If bleach or other additives are used, the pipe should be extended and connected to a ventilation system.

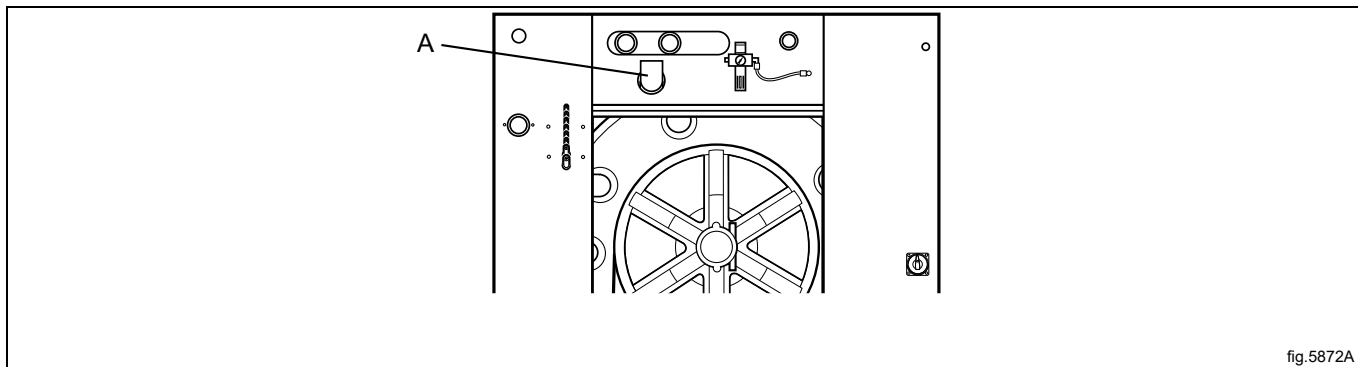

10 Detergent supply injector

If only non-liquid detergents are to be used in the detergent supply injector, the following adaptation is recommended:

Drill two \varnothing 5 mm / 3/16 inch holes in the bottom of each cup to allow any water left to drain off.

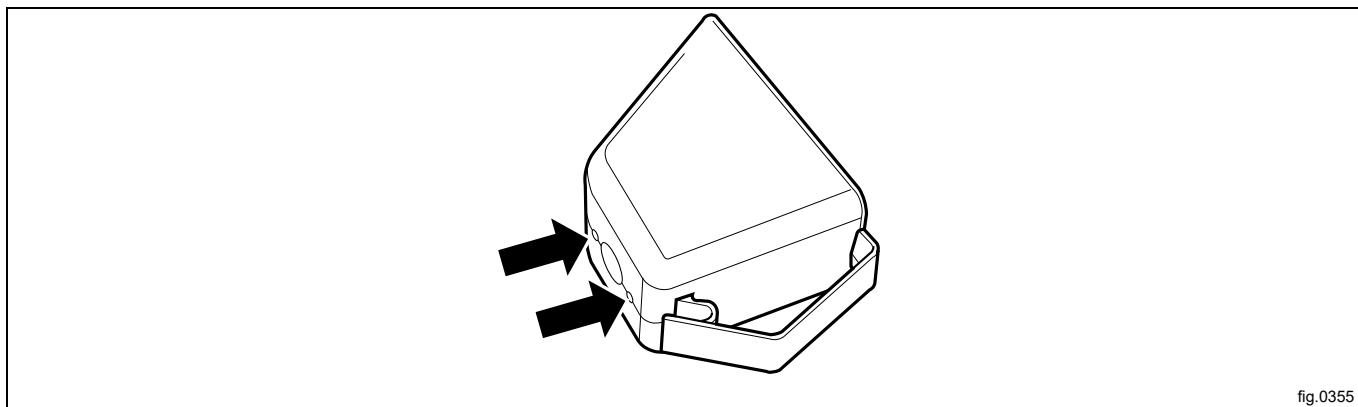

11 Connection of external dosing systems

11.1 Connection of the hoses

Note!

All external equipment which is connected to the machine must be CE/EMC-approved.

The machine is prepared for connection of external dosing systems or water re-use systems etc.

The connections are closed at delivery. Open any of the connections that shall be used by drilling a hole where the hoses shall be connected.

Note!

Make sure there is no burrs left after drilling. When removing burrs make sure burrs does not fall into the siphon breaker.

A = \varnothing 10 mm / 3/8 inch (outer dimension), drill \varnothing 5 mm / 3/16 inch

Use the enclosed template by putting it over the connection and drill in the hole.

B = \varnothing 16 mm / 5/8 inch (outer dimension), drill \varnothing 11 mm / 7/16 inch

C = \varnothing 20 mm / 13/16 inch (outer dimension), drill \varnothing 15 mm / 9/16 inch

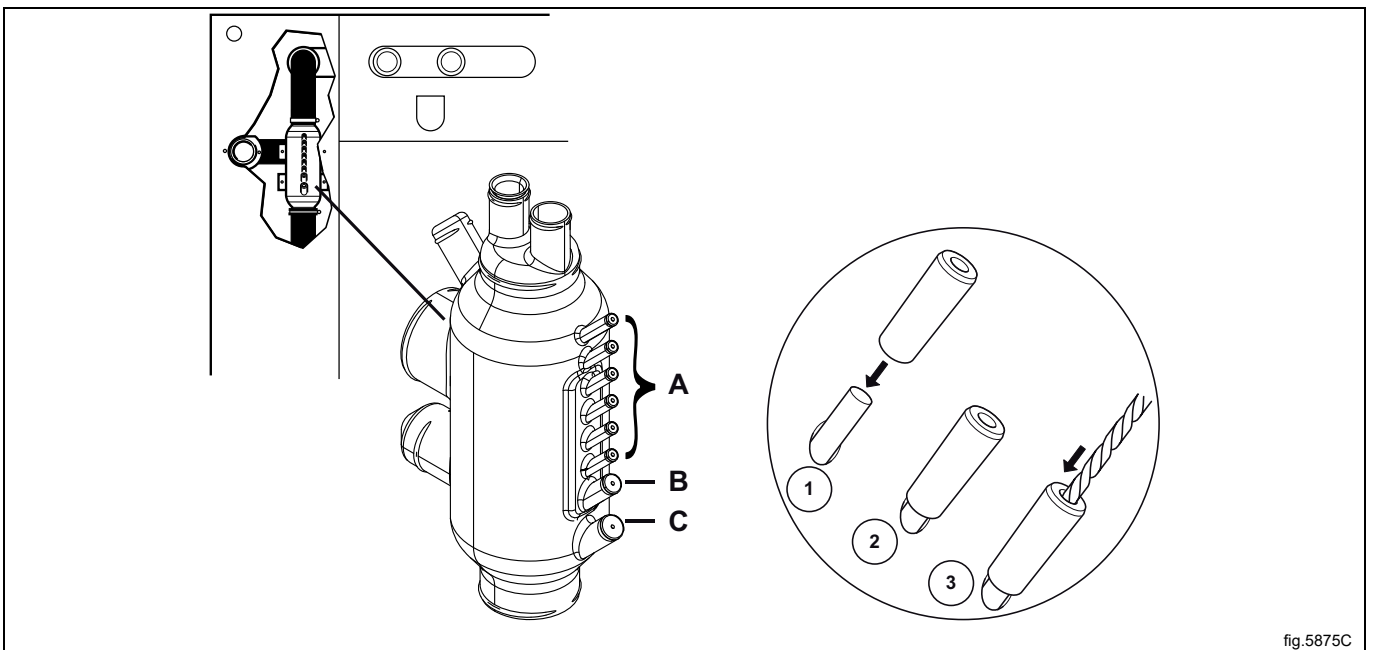

fig.5875C

11.2 Electrical connection of external dosing system



The electrical installation may only be carried out by qualified personnel.

The external dosage unit connects to the X146 via the upper terminal in the coin operation unit. There are a total of 8 outlets for the dosing of washing detergent. The number on the terminal corresponds to the numbering of the liquid detergent function when setting the wash program.

A common zero for all the outlets can be found on the X146 terminal "Neutral". 230 V max 0.5 A only intended for control voltage. If the machine is not fitted with a detergent container, then additional signals can be received from X140.

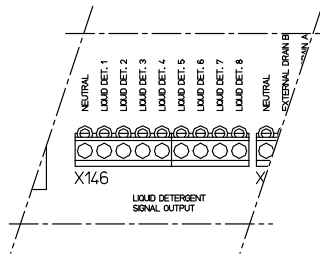

fig.6527

12 Electrical connection



The electrical installation may only be carried out by qualified personnel.

The electrical cable for the machine's power supply should hang in a gentle arc. (This is particularly important if the machine is fitted with a tilting or weighing function).

Connect the machine to a separate mains circuit with its own circuit breaker(s). The various ratings required for circuit breakers are shown in the table.

Connect the cable to the main switch inside the electrical cabinet at the back of the machine.

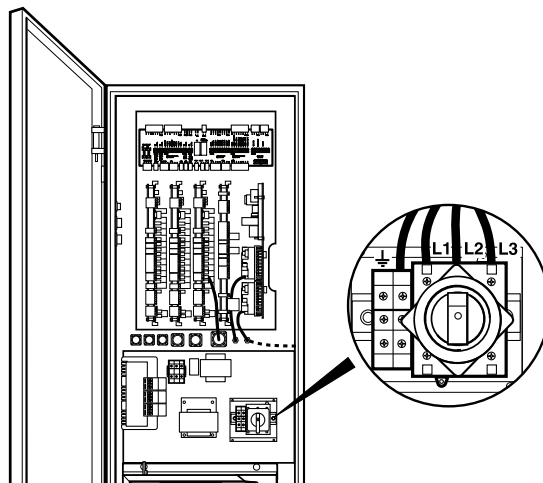

fig.6585

Note!

Check that the motor controller is energized. If not; the machine is connected with wrong phase sequence. If so; swap two phases according to the illustration. Depending on different machine model, the connection terminal can be one of the examples.

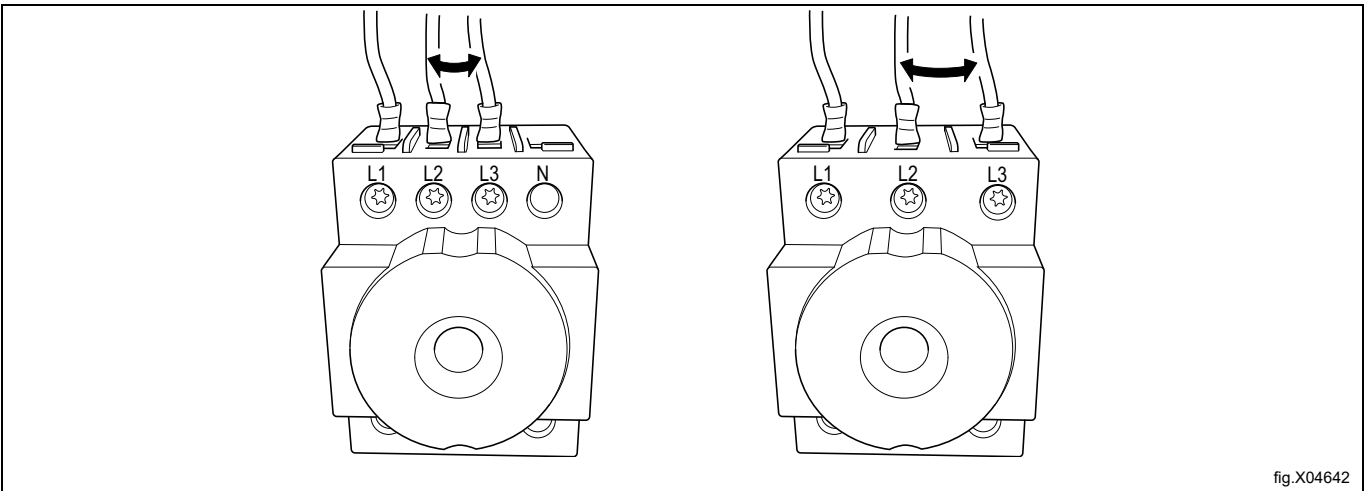

fig.X04642

Check that the earth conductor is correctly connected.

The electrical cable used must be of a suitable size/rating. For the correct size/rating for this cable, check the relevant local or national regulations.

If an earth leakage circuit breaker (or RCD - residual current device) is used, it must be installed to protect the machine only.

Switching to 208V or 200–208V

Remove the middle panel at the back of the machine and remove the protective plate covering the transformer.

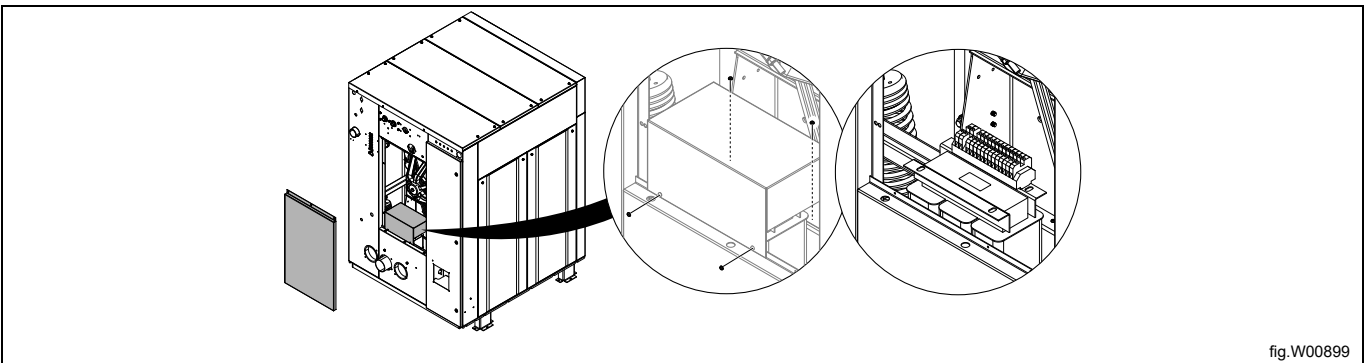
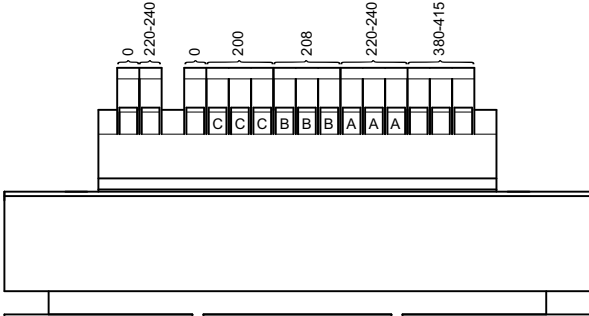
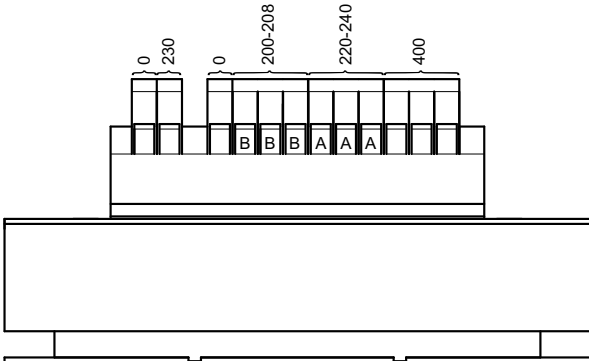
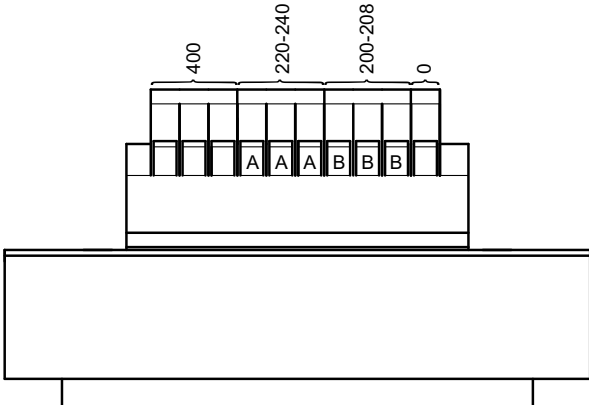

fig.W00899

Reconnect the primary power supply to the transformer as follows:

W4400H	<p>Move the cables from position A to position B for a 208 V supply. Move the cables from position A to position C for a 200 V supply. The other cables are not changed.</p>	 <p>The diagram shows a terminal block with 12 positions. From left to right, the positions are labeled: 0, 220-240, 0, 200, 208, 220-240, 380-415. Below these labels, the terminal positions are grouped into three sets of three. The first set (positions 1-3) is labeled 'C', the second set (positions 4-6) is labeled 'B', and the third set (positions 7-9) is labeled 'A'. Arrows indicate the movement of cables from the 'A' group to the 'B' group for 208V and from 'A' to 'C' for 200V.</p>
W4600H	<p>Move the cables from position A to position B for a 200-208 V supply. The other cables are not changed.</p>	 <p>The diagram shows a terminal block with 12 positions. From left to right, the positions are labeled: 0, 230, 0, 200-208, 220-240, 400. Below these labels, the terminal positions are grouped into three sets of three. The first set (positions 1-3) is labeled 'B', the second set (positions 4-6) is labeled 'A', and the third set (positions 7-9) is labeled 'A'. Arrows indicate the movement of cables from the 'A' groups to the 'B' group for 200-208V.</p>
W4850H W41100H	<p>Move the cables from position A to position B for a 200-208 V supply. The other cables are not changed.</p>	 <p>The diagram shows a terminal block with 12 positions. From left to right, the positions are labeled: 400, 220-240, 200-208, 0. Below these labels, the terminal positions are grouped into three sets of three. The first set (positions 1-3) is labeled 'A', the second set (positions 4-6) is labeled 'B', and the third set (positions 7-9) is labeled 'B'. Arrows indicate the movement of cables from the 'A' group to the 'B' groups for 200-208V.</p>

12.1 Electrical connections

W4400H

Heating alternative	Main voltage	Hz	Heating power kW	Total power kW	Recommended ITCB A
Electric heated	208-240V 3 ~	60	36.0	38.0	125
	440V 3 ~	60	36.0	38.0	70
	480V 3 ~	60	36.0	38.0	60
Non heated/Steam heated	440/480V 3 ~	60	-	4.5	15
	208-240V 3 ~	60	-	4.5	15

W4600H

Heating alternative	Main voltage	Hz	Heating power kW	Total power kW	Recommended ITCB A
Electric heated	208-240V 3 ~	60	38.4/54.0	41.0/56.5	125/200
	440V 3 ~	60	38.4/54.0	41.0/56.5	70/100
	480V 3 ~	60	38.4/54.0	41.0/56.5	70/100
Non heated/Steam heated	208-240V 3 ~	60	-	4.8	15
	440/480V 3 ~	60	-	4.8	15

W4850H

Heating alternative	Main voltage	Hz	Heating power kW	Total power kW	Recommended ITCB A
Non heated/Steam heated	208-240V 3 ~	60	-	6.3	30
	440/480V 3 ~	60	-	6.3	15

W41100H

Heating alternative	Main voltage	Hz	Heating power kW	Total power kW	Recommended ITCB A
Non heated/Steam heated	208-240V 3 ~	60	-	6.3	30
	440/480V 3 ~	60	-	6.3	15

13 Installation of machines with tilt function

Remove the side panels, the rear panel and the lower front panel.

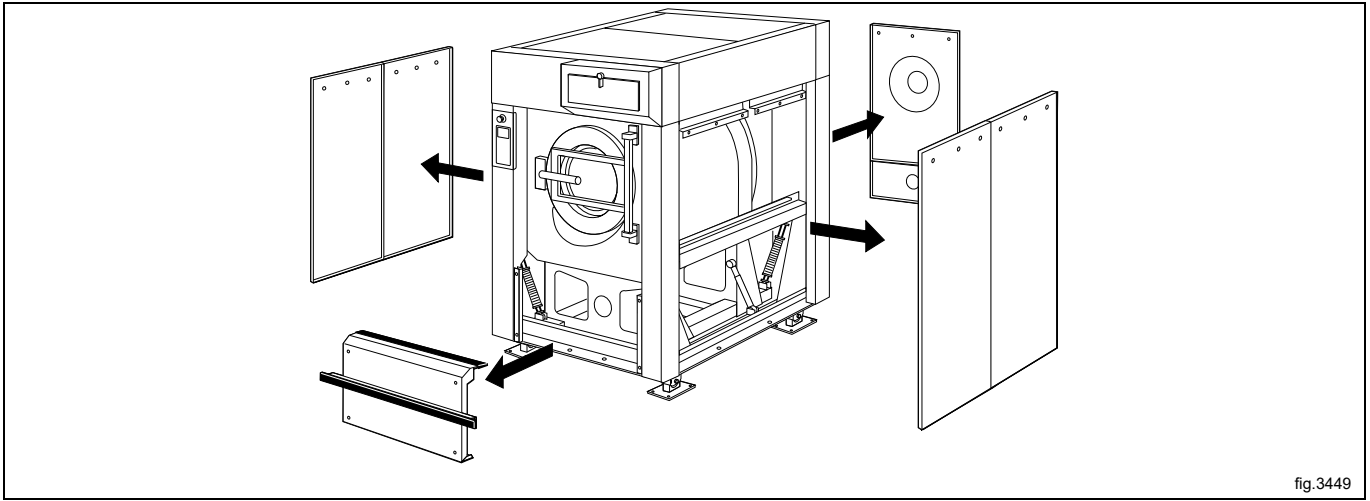

fig.3449

For machines with tilt both forwards and backwards

Insert the two cylinder units (A) from the side of the machine underneath the machine frame.

If there is vinyl floor-covering on the floor: To protect the floor from wear, a sheet of stainless steel should be laid beneath each cylinder.

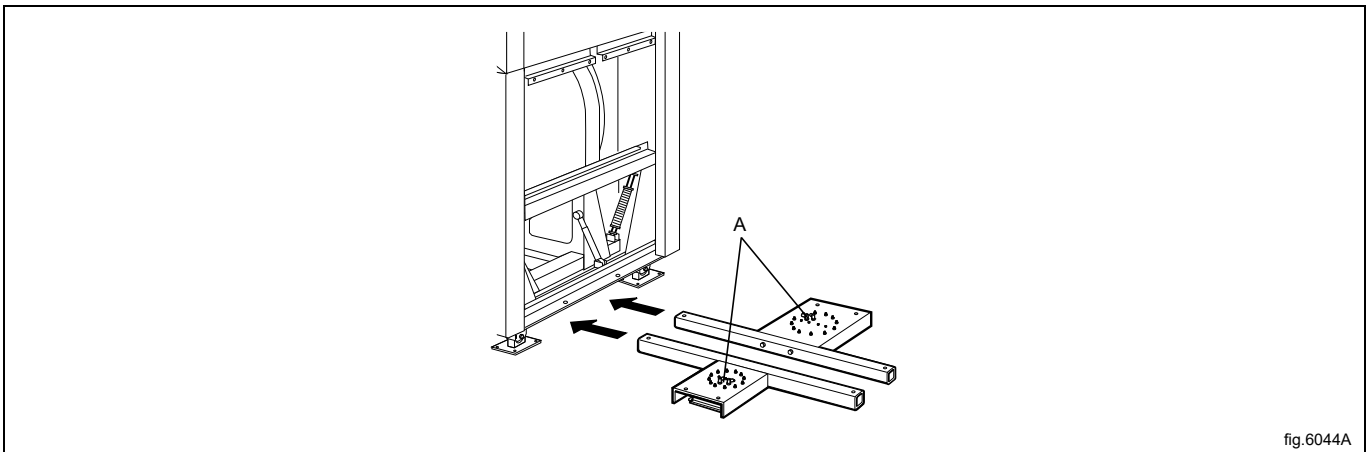

fig.6044A

For machines with forward tilt only

Insert the cylinder unit (A) from the side of the machine underneath the rear section of the machine frame.

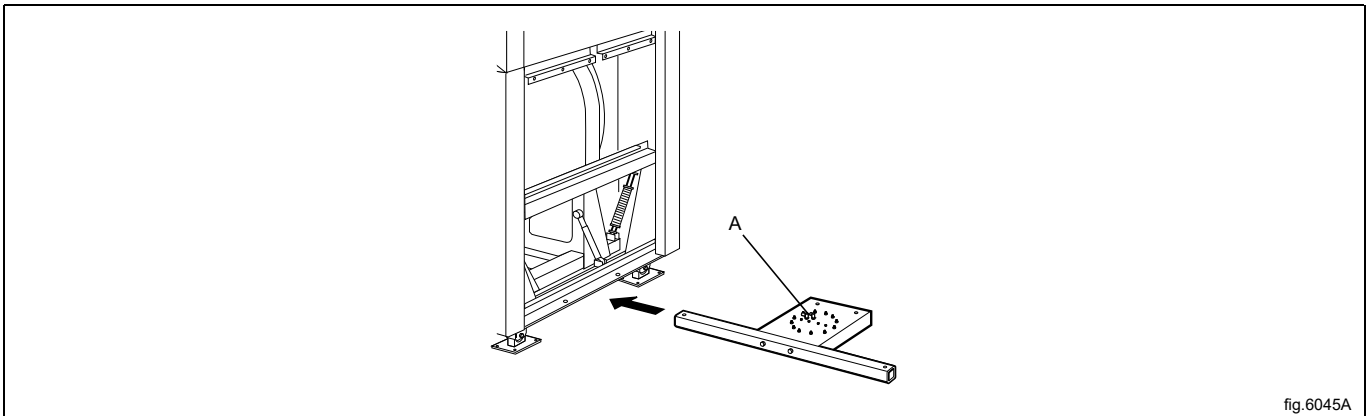

fig.6045A

Secure the cylinder units using four bolts and nuts.

Note!

It is important to fit four washers (B) (each 5 mm thick) between each cylinder unit and the machine frame.

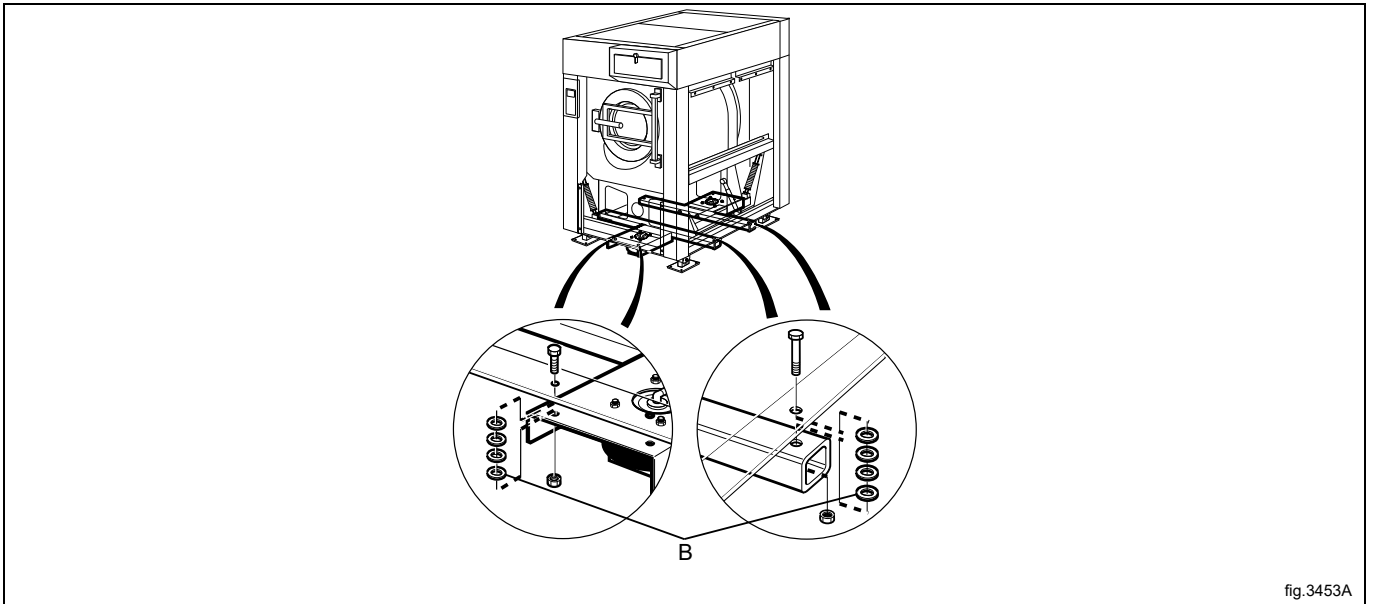

fig.3453A

Fit the four corner posts, one for each corner of the machine, using the bolts which secure the machine feet to the floor. Adjust the clearance between the upper part of each corner post and the machine so it is 14 mm.

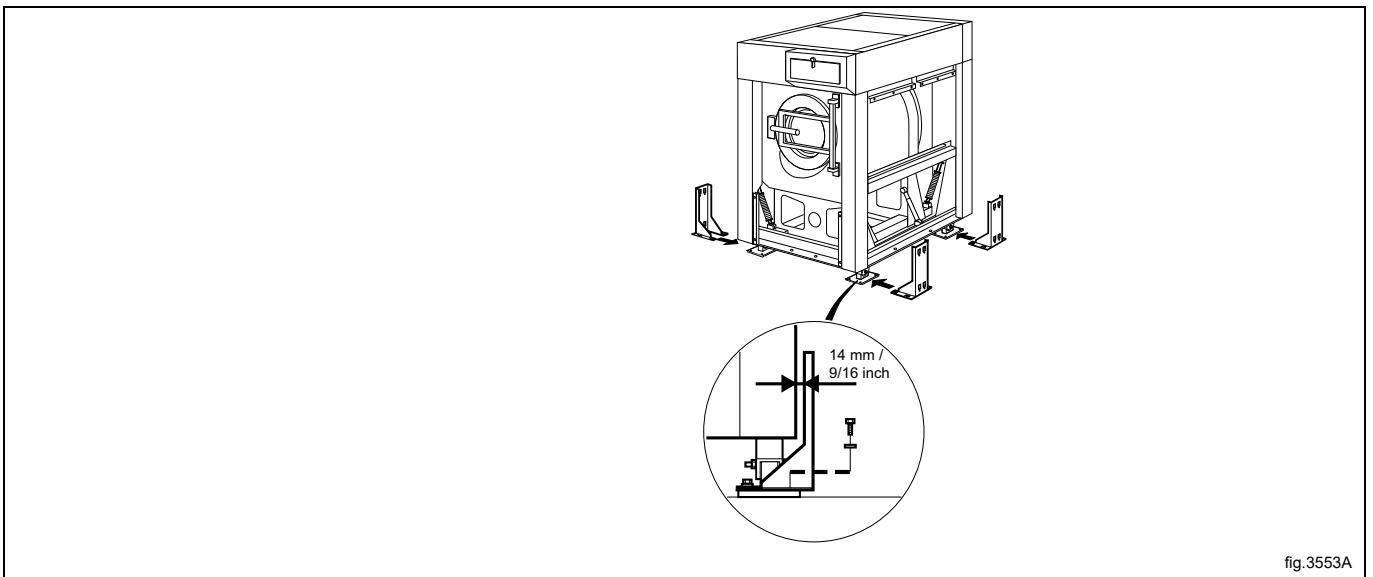

fig.3553A

For machines with tilt both forwards and backwards

Fit two pneumatic position sensors (C) on two of the machine feet: at left-hand front and right-hand rear, diagonally opposed. The position sensors are to be fitted using the inner two fastening bolts of the feet, mounted on the corner posts just installed.

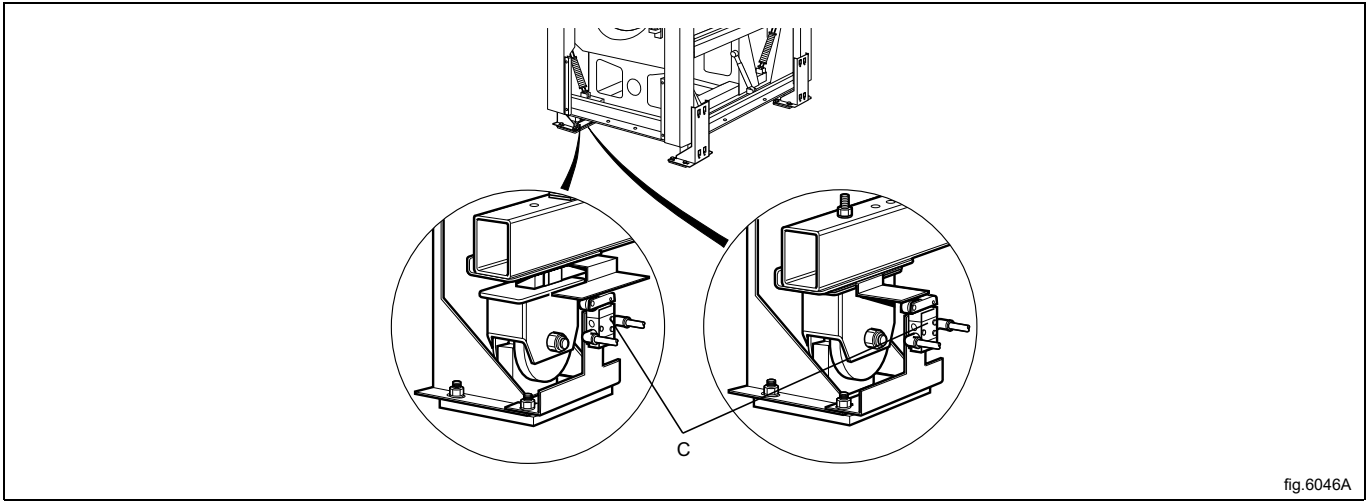

fig.6046A

The compressed air lines which are to be connected to the air bellows and position sensors are supplied bundled on the machine rear.

Connect the lines to the air bellows and pressure sensors according to the table below. These lines do not need to be fastened to the frame, but can be laid on the floor underneath the machine.

The air lines are marked as follows:

ID marking	Connect to
1	Rear air bellows
2	Front air bellows
3	Rear pressure sensor, connection 1
4	Rear pressure sensor, connection 2
5	Front pressure sensor, connection 1
6	Front pressure sensor, connection 2

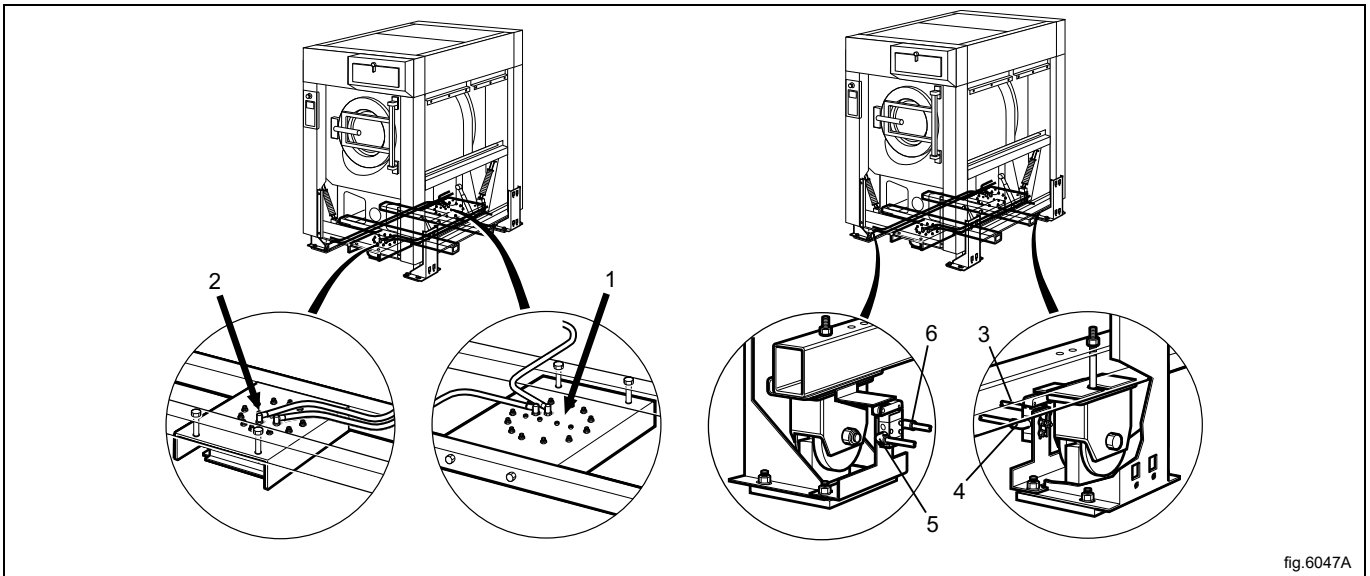

fig.6047A

Note that the tubes for the pressure sensors must be connected correctly.

- Connection 1 – same side as data plate.
- Connection 2 – same side as the inset white plate.

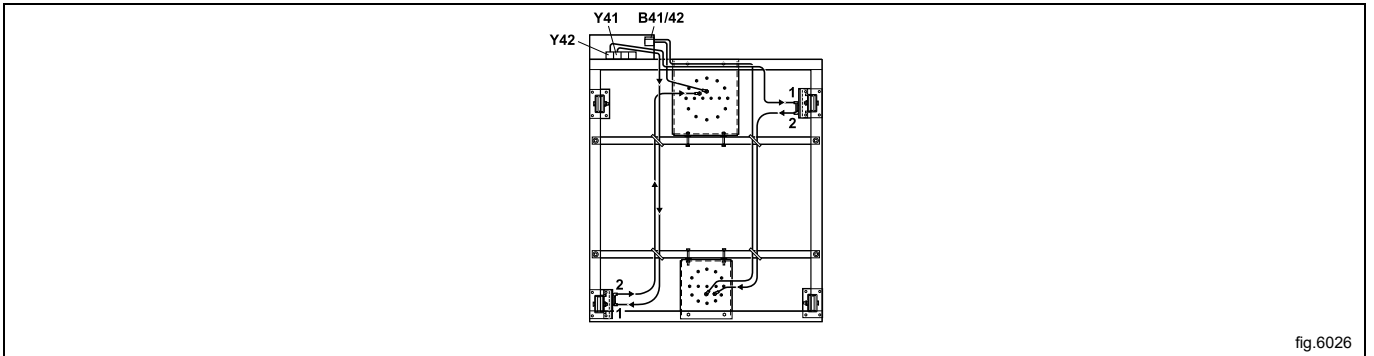

fig.6026

For machines with forward tilt only

The compressed air line to be connected to the air bellows is supplied bundled on the machine rear. Connect this line to the connection nipple on the top of the bellows.

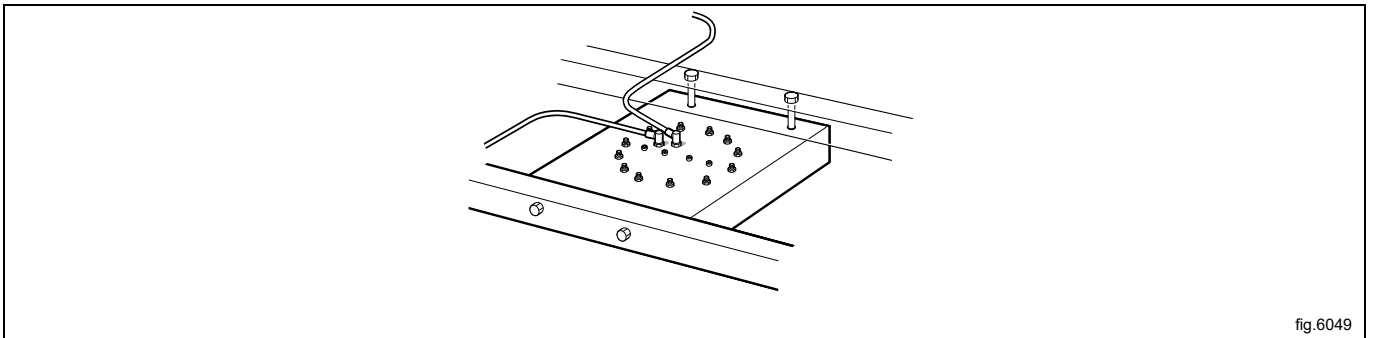

fig.6049

Before refitting the panels, test the tilt function:

- Switch on the machine electrical switch(es) and turn on the compressed air supply.
- Open the door and lock it open.
- The uppermost switch on the tilt control unit tilts the machine either backwards (turn switch counter clockwise) or forwards (turn switch clockwise). The middle switch returns the machine to its normal (upright) position. These switches must be kept actuated throughout the entire tilt movement. If the switch is released, the tilt movement will halt and the machine will stop in its position.
- The bottom switch on the control unit rotates the drum either clockwise or counter clockwise.
- Check that the machine cannot tilt in the opposite direction until it has returned to its normal position after an earlier tilt.
- Check for any possible leaks from compressed air lines or from bellows and sensors.

If the test is OK, refit the machine panels/covers.



fig.6025

Fit two nut clips (D) to each corner post. The nut clips slot into the rear grooves on the posts.

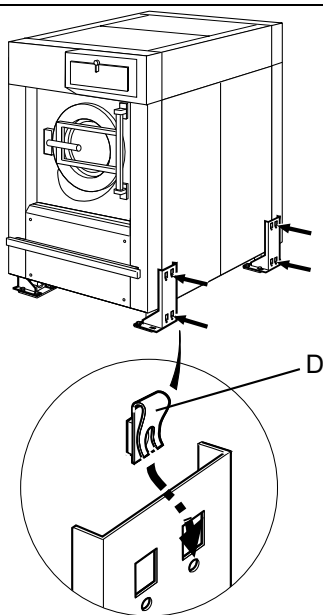
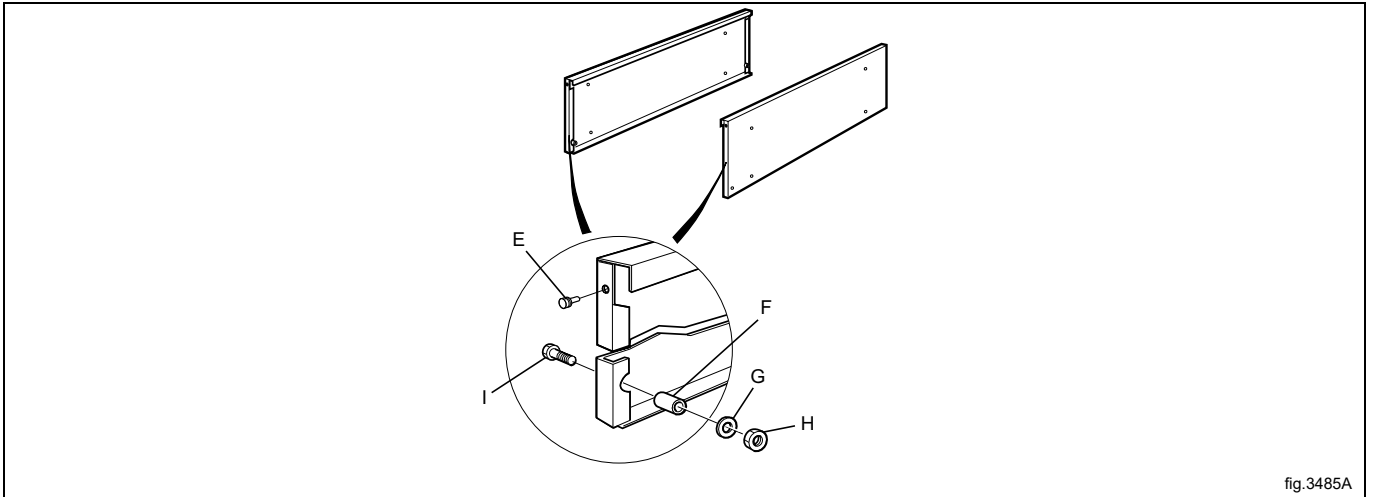
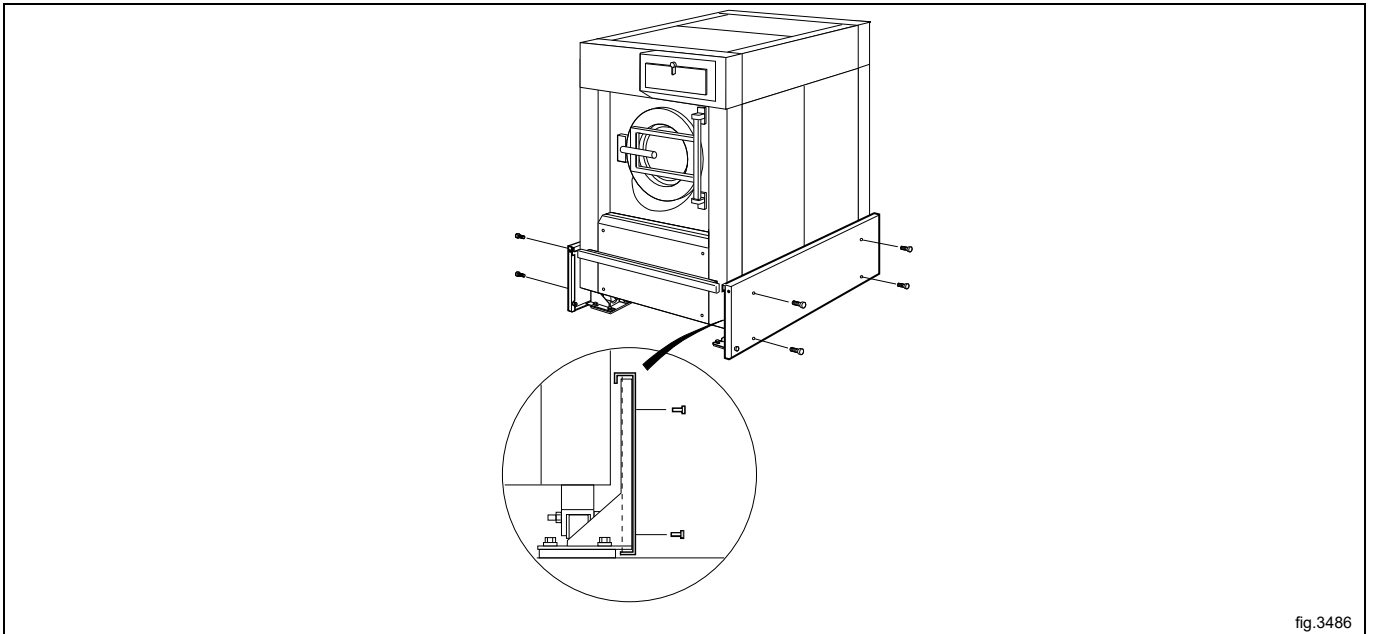

fig.3484A

Fit the rubber dampers (E) and sleeves (F) to the front end of each side panel strip. Washer (G), nut (H), screw (I).



Position and fasten the side panel strips.



Fit the two counterweights to the front panel strip. The bolt heads should be at the bottom.

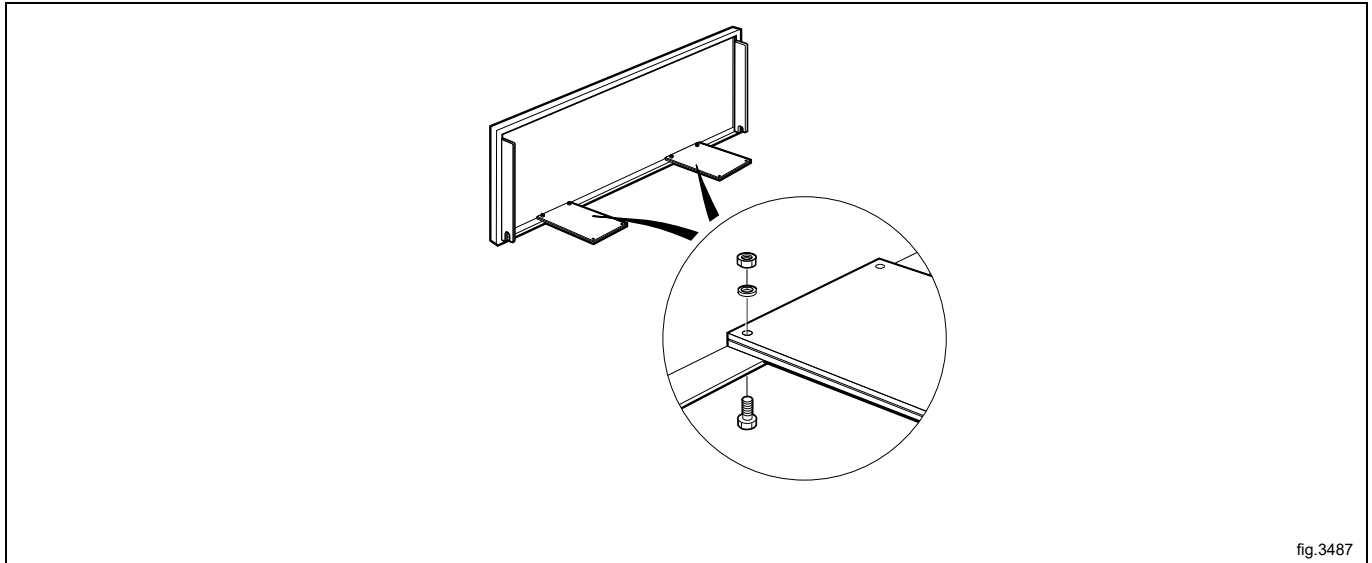

Hang the front panel strip on the two sleeves fitted to the side strips. Protective plates are mounted on the front and rear.

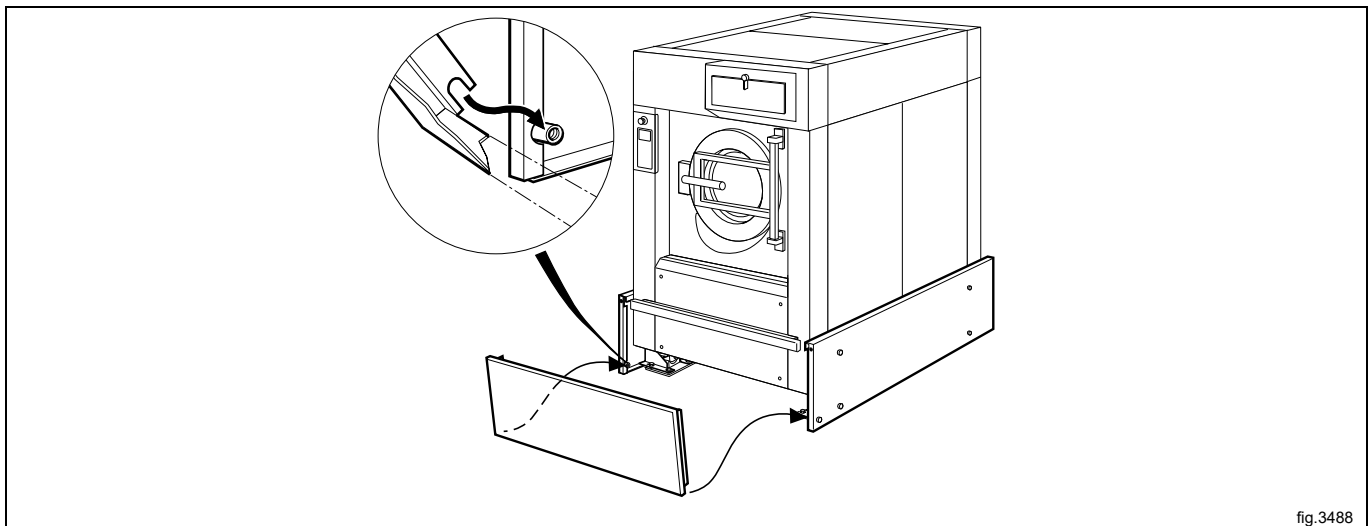

14 Disposal information

14.1 Appliance recyclability and disposal

14.1.1 Recyclability

Our appliances are manufactured using a significant percentage of recyclable metals (such as stainless steel, iron, aluminium, galvanized sheet, copper, etc.), which can be recovered through the local recycling systems, in compliance with the regulations in force in the country of use.

National regulations regarding waste disposal may vary. Disposal of the appliance must therefore be carried out in accordance with the applicable legislation and the directives issued by the competent authorities in the country where the appliance is decommissioned.

The components of the appliance must be separated and disposed of in accordance with their material composition (e.g. metals, oils, greases, plastics, rubber, refrigerant gases, insulating boards and other insulating material, glass wool, LEDs, etc.) and in full compliance with applicable local and international waste management regulations.

Compressors may contain oils and refrigerants fluids - are special waste and has to be recycled on local bases regulations.

14.1.2 Procedure regarding appliance disposal and component / material recovery

This product should not simply be disposed of in the environment at the end of its life cycle; it is imperative instead either to dispose of it in accordance with local environmental regulations, or, preferably, to deliver it whole to an authorized recycling center.

All removed components, including doors and other structural parts, must be delivered together with the appliance to an authorized recycling or dismantling facility.

The dismantling/recycling center will apply state of the art technologies and methods available to them to effectively disassemble the products for best recyclability.

Note that printed circuit boards, electrical motors or other components identified in European Union legislation to be of high critical raw materials recovery potential need to be addressed specifically.

In case of doubts or questions, always refer to your reference customer care service.

Before disposing of the appliance, carefully inspect its physical condition and preservation state, checking for potential leaks of liquids or gases, as well as for broken parts that may pose hazards during handling and subsequent dismantling.



The symbol on the product indicates that this product should not be treated as domestic waste, but must be correctly disposed of in order to prevent any negative consequences for the environment and human health. For further information on the recycling of this product, contact the local dealer or agent, the customer care service or the local body responsible for waste disposal.



Note!

When dismantling the appliance, any marking, this manual and other documents concerning the appliance must be destroyed.

14.2 Disposal of packing

The packing must be disposed of in compliance with the current regulations in the country where the appliance is used. All the packing materials are environmentally friendly.

They can be safely kept, recycled or burned in an appropriate waste incineration plant. Recyclable plastic parts are marked as following examples.

	Polyethylene: <ul style="list-style-type: none"> • Outer wrapping • Instructions bag
	Polypropylene: <ul style="list-style-type: none"> • Straps
	Polystyrene foam: <ul style="list-style-type: none"> • Corner protectors



www.electroluxprofessional.com